

IT-36CI



## FEATURES

Dual refrigeration keeps food fresher longer

Air purification system fights spoilage, odors

Water-filtration system for ice reduces contaminants, chlorine taste and odor

Automatic ice maker with "max ice" feature

Over-and-under refrigerator/freezer storage

Every Sub-Zero integrated refrigerator or freezer comes ready to be fitted with custom panels and handles for seamless installation with surrounding cabinetry

Rigorously tested in our U.S. manufacturing facilities to ensure at least 20 years of heavy use

Exceptional 24/7 support from our Customer Care team based in Madison, Wisconsin and just footsteps from our factory

## ACCESSORIES

Dual installation kits

Stainless steel front panels with tubular or pro handles

Stainless steel kickplate

Stainless steel pro handles

Stainless steel tubular handles

Replacement air purification cartridge and water filter

Dozen egg container

Accessories are available through an authorized Sub-Zero dealer. For local dealer information, visit [subzero-wolf.com/locator](http://subzero-wolf.com/locator).



## HANDLE ACCESSORIES

PRO



TUBULAR



## PRODUCT DETAILS

### REFRIGERATOR

- 3 Adjustable glass shelves
- 1 Stationary shelf
- Crisper drawer with 2 adjustable dividers
- Adjustable dairy compartment
- 2 Adjustable door shelves
- 1 Stationary door shelf

### FREEZER

- 3 Adjustable drawer dividers
- Removable ice container
- Automatic ice maker

## PRODUCT SPECIFICATIONS

|                       |   |
|-----------------------|---|
| Model                 | IT-36CI   |
| Dimensions            | 36"W x 84"H x 24"D                                    |
| Door Clearance        | 34 1/2"   |
| Drawer Clearance      | 18 3/8"   |
| Weight                | 460 lb  |
| Refrigerator Capacity | 13.3 cu ft  |
| Freezer Capacity      | 6.4 cu ft   |
| Electrical Supply     | 115 VAC, 60 Hz  |
| Electrical Service    | 15 amp dedicated circuit                              |
| Plumbing Supply       | 1/4" OD copper, braided stainless steel or PEX tubing |
| Plumbing Pressure     | 35–120 psi  |

## ELECTRICAL

## PLUMBING

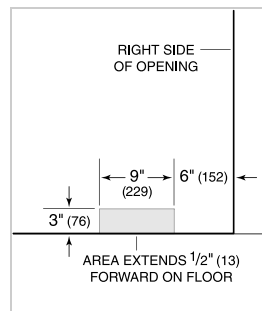
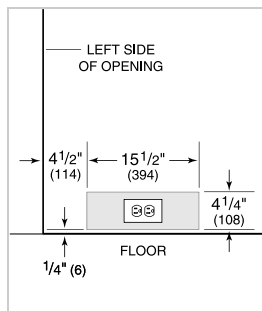

## PANEL SPECIFICATIONS

For complete panels specifications including width/height, weight requirements and thickness requirements visit [subzero-wolf.com/integratedconfigurator](http://subzero-wolf.com/integratedconfigurator).

## INTERIOR VIEW

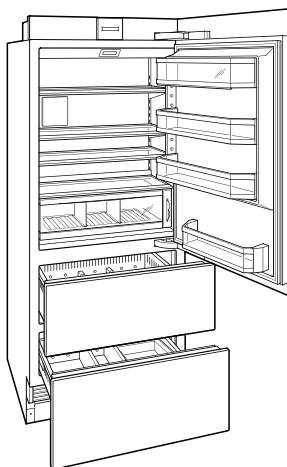

This illustration is intended for interior reference only and may not represent the exterior of the model being specified.

## DIMENSIONS

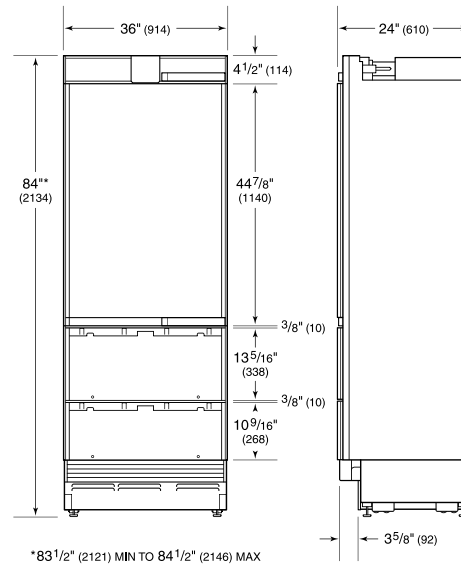

\*83 1/2" (2121) MIN TO 84 1/2" (2146) MAX

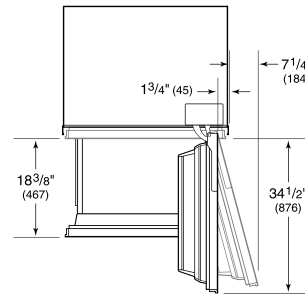

## STANDARD INSTALLATION

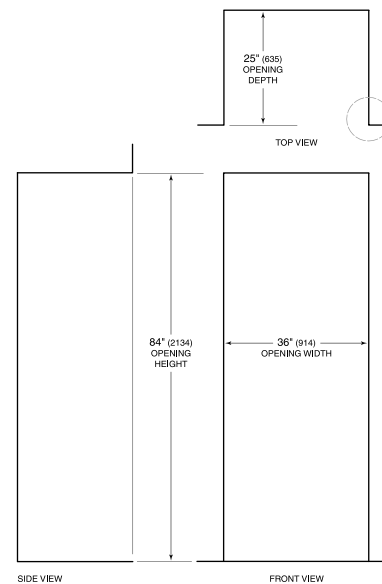

SIDE VIEW

FRONT VIEW

NOTE: 3/16" (89) finished returns will be visible and should be finished to match cabinetry.

