

# AM18W

Adjustable Height Swingout Mount for Small Flat-Panels

LIST \$850.00	Color: White
Weight	27.00 lb.   12.2 kg
Weight Cap. per Head	18 lb.   8.2 kg
Mounting Pattern	75 x 75, 100 x 100 mm
Display Range	10.00 - 20.00 in
Tilt	+90.00° / -90.00°
Pivot	+90.00° / -90.00°
Rotation	+360°

Downloads at Mounts.com



[Data Sheet](#)



[Bid Specification Document](#)



18 lb.



+90.00°  
-90.00°



75 x 75



100 x 100



10-20 in

## DESCRIPTION

This adjustable height swingout mount for small flat-panels was designed for the healthcare industry. The AM18W supports flat-panels up to 18 lbs or with a VESA mounting pattern of 75x75mm or 100x100mm. The flexible mounting arm extends up to 63in and includes a built-in double gas spring system that aids in height and length adjustment. Mounting head offers tilt, swivel and rotation.

## FEATURES

- 90° of omnidirectional movement
- Key hole mounting slots for faster installations
- Smoothly extends up to 63 in. for comfortable viewing
- Designed for the healthcare industry (i.e. hospitals, dentist office)
- Cable management to keep power and signal protected and organized.

# AM18W

Adjustable Height Swingout Mount for Small Flat-Panels

DOWNLOAD FULL SIZE CAD FILES AND DIMENSIONAL DRAWINGS AT MOUNTS.COM

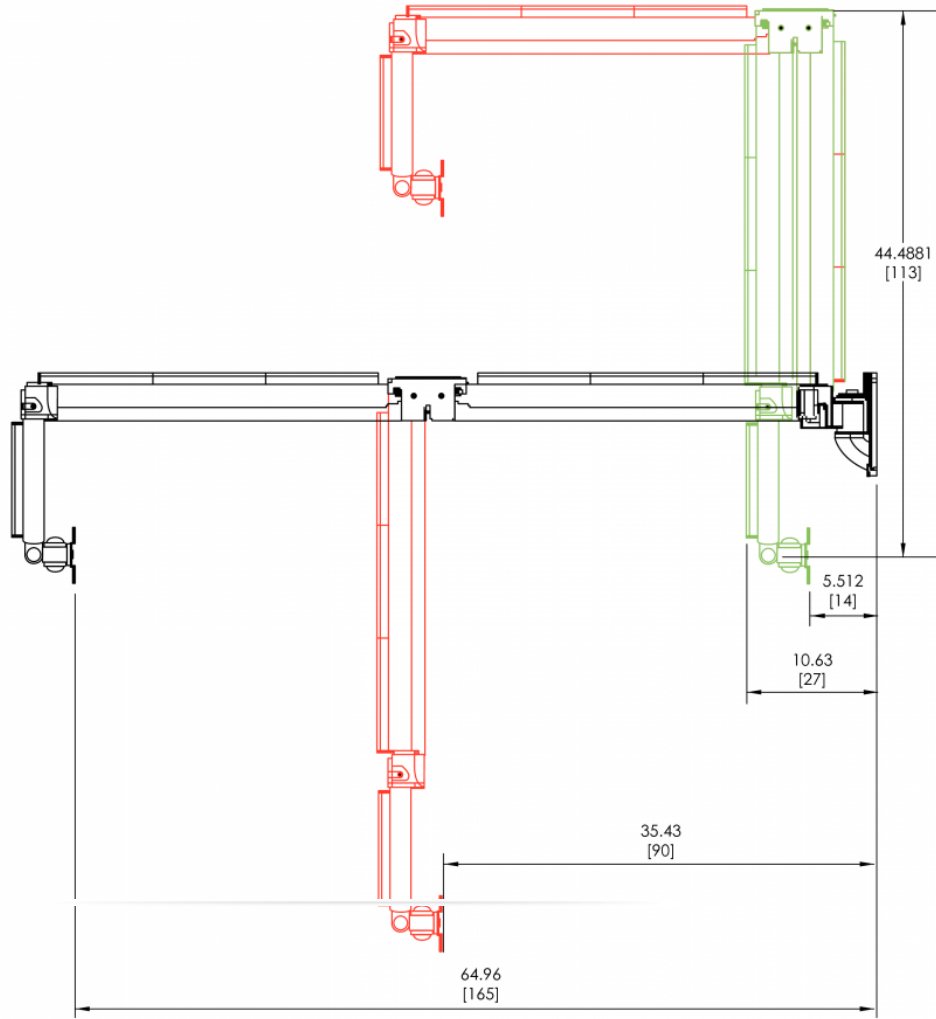

World Headquarters | 1321 S. State College Blvd., Fullerton, CA 92831 | 800.368.9700 USA | F 800.832.4888 | [www.mounts.com](http://www.mounts.com)

© 2014 PREMIER MOUNTS | Rev.01 | 10.2011