

External Accessory Control Module Installation Manual KAC-001

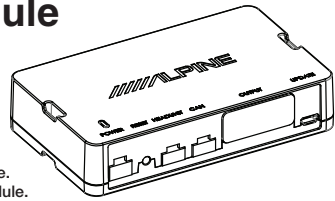

* Only compatible with Alpine head units with the external accessory control feature.
* ADS i-DataLink Maestro is required to operate this external accessory control module.

Thank you for purchasing this Alpine product. Please take a moment to protect your purchase by registering your product now at the following address:
www.alpine-usa.com/registration.
You will be informed of product and software updates (if applicable), special promotions and news about Alpine.

Disclaimer

The KAC-001 External Accessory Control Module works with various accessory products manufactured by third parties. Please review and follow all manufacturer's instructions and warnings for all accessory products.

Introduction

- Design and specifications are subject to change without notice for improvement.
- This product has 8 low current outputs designed to control a number of third party accessories.

To Ensure Safe Use, Always Follow These Precautions

- The installation of this product requires specialized skills and experience. We recommend that you have the product installed by the store that you purchased it from.
- Before you use this product, be sure to carefully read this installation manual and the separate user's manual so that you can use the product correctly. Alpine Electronics bears no responsibility for problems that arise as a result of failure to follow the instructions in the manuals.
- This manual includes a number of symbols that are intended to help you use the product safely, to prevent harm to you and others, and to protect against damage to property. These symbols and their meanings are listed below. Make sure you fully understand these symbols before you begin reading the main text.

Explanations of Injury and Damage That May Result from Incorrect Use

	Warning	Ignoring the content marked by this indication and using the product incorrectly is expected to lead to death or serious injury.
	Caution	Ignoring the content marked by this indication and using the product incorrectly is only expected to lead to injury or property damage.

	Indicates actions that are forbidden (must not be performed)		Indicates actions that are mandatory (must be performed)
	Indicates that disassembly is forbidden.		Marks content that should receive your full attention.

Warning

Do not disassemble or modify the product. Doing so could lead to an accident, fire, or electric shock.



Store screws and other small objects where small children cannot reach them. If one of these small objects is swallowed, consult with a doctor immediately.



When replacing fuses, be sure to use fuses with the specified current rating. Failing to do so could lead to an accident or fire.



Only connect the product to a 12 VDC negative ground car. Failing to do so could lead to an accident or fire.



Before you begin wiring, remove the ground wire from the negative terminal of the battery. Failing to do so could lead to electric shock or injury.



Do not cut the insulation on a cord and take power from another device. Doing so could lead to fire or electric shock.



Do not install the product in a location where it will obstruct the driver's forward view; interfere with the operation of the steering wheel, gearshift, or the like; or pose a threat to passengers. Doing so could lead to an accident or injury.



When making a hole in the vehicle body, be careful to avoid damaging pipes, the fuel tank, electrical wiring, and the like. This kind of damage could lead to an accident or fire.



When installing and grounding the product, do not use any of the bolts or nuts of the steering wheel, brakes, fuel tank, or the like. Doing so could make the brakes stop working or lead to fire.



Do not install the product near the passenger-side airbag. Doing so could interfere with the operation of the airbag and lead to an accident or injury.



Bundle cords so that they don't interfere with driving. Wrapping cords around the steering wheel, gearshift, brake pedal, or the like, could lead to an accident or damage equipment.



Take caution when wiring outputs to avoid unintentionally discharging the battery.



Caution

Connect the product properly according to the instructions. Failing to do so could lead to fire or an accident.



Do not sandwich cords between the seat railing or allow them to touch protrusions. Resulting breaks or shorts could lead to electric shock or fire.



Do not block vents or heat sinks. Doing so could lead to fire or damage equipment.



Use the accessories according to the instructions, and attach them securely. Failing to do so could lead to an accident or damage equipment.



Do not install the product where it may be exposed to water or in a place with high levels of humidity or dust. Doing so could lead to fire or damage equipment.



The installation and wiring of this product requires specialized skills and experience. Have the product installed and wired by the store that you purchased it from.



Accessory List

Interface Module	Power Harness	Interface Harness
	 <small>*Fuse Rating: 7A</small>	
8ch Output Harness	Installation Manual	

Component Connector View

SIDE VIEW

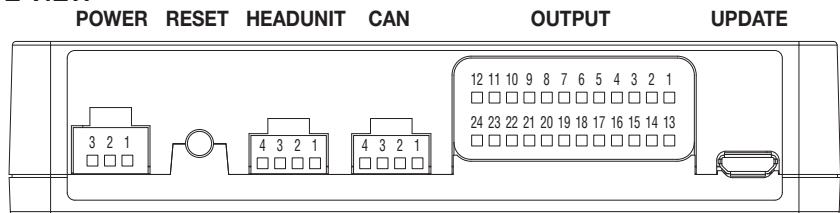

POWER (3-Pin White Connector)

Pin #	Color	Application	Detail
1	BLACK	Ground Lead	Connect this lead to a good chassis ground on the vehicle. Make sure the connection is made to bare metal and is securely fastened.
2	RED	Ignition	Connect this lead to an open terminal on the vehicle's fuse box or another unused power source which provides (+) 12V only when the ignition is turned on or in the accessory position.
3	YELLOW	Battery Lead	Connect a fused 12V DC lead to the positive (+) post of the vehicle battery.

OUTPUT (24-Pin Blue Connector)

Pin #	Color	Application	Detail
17	PURPLE	Output 1	(-) 250mA Accessory output
5	WHITE/RED	Output 2	(-) 250mA Accessory output
18	BROWN	Output 3	(-) 250mA Accessory output
6	BLUE	Output 4	(-) 250mA Accessory output
19	GREEN	Output 5	(-) 250mA Accessory output
7	PINK	Output 6	(-) 250mA Accessory output
20	WHITE	Output 7	(-) 250mA Accessory output
8	GRAY	Output 8	(-) 250mA Accessory output

Connection

- This product has a maximum negative trigger output of 250mA. An automotive grade Bosch-style 12V relay may be necessary for higher current accessories. (Sold separately)
- ADS i-Datalink Maestro is required to operate this external accessory control module.
- For 3rd party controlled accessories, please refer to the corresponding installation manual.

SIDE VIEW

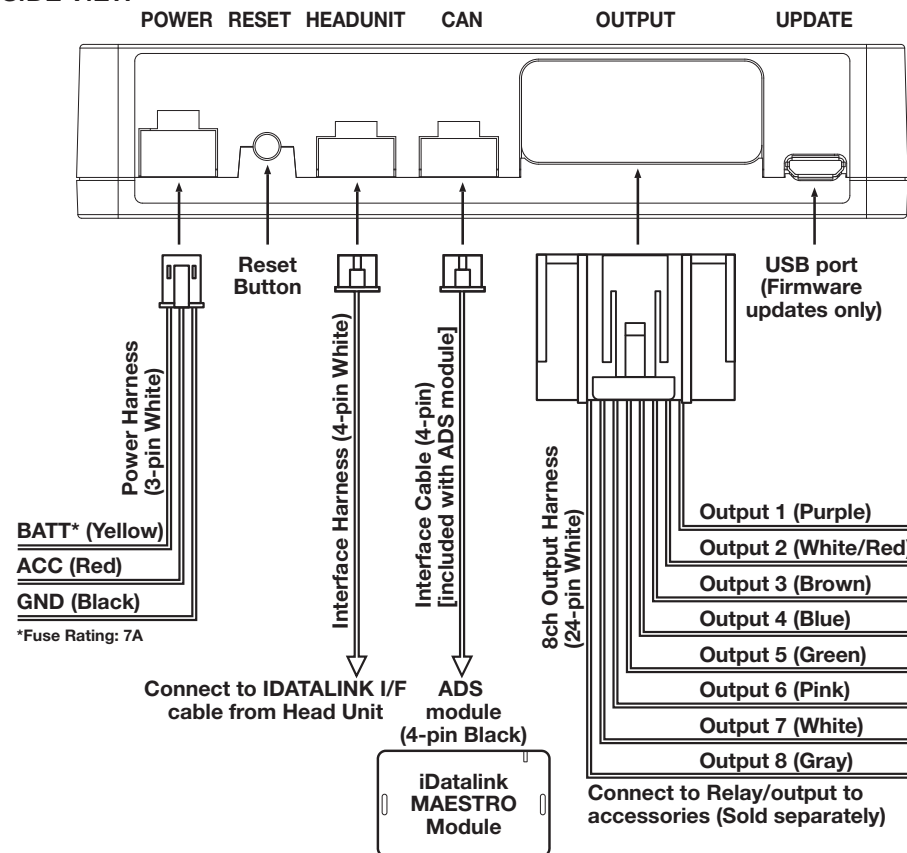

Warning
 IMPROPER INSTALLATION MAY RESULT IN SERIOUS DAMAGE OR INJURY INCLUDING ELECTRICAL SHOCK, AND INTERFERENCE WITH THE OPERATION OF THE VEHICLE.

Warning
 IMPROPER INSTALLATION MAY RESULT IN SERIOUS DAMAGE OR INJURY INCLUDING ELECTRICAL SHOCK, AND INTERFERENCE WITH THE OPERATION OF THE VEHICLE.

System Diagram

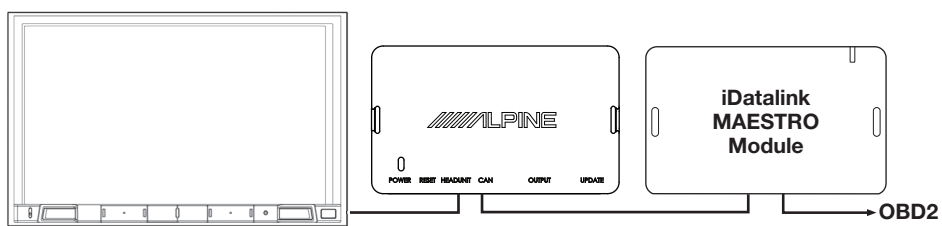

Relay Installation

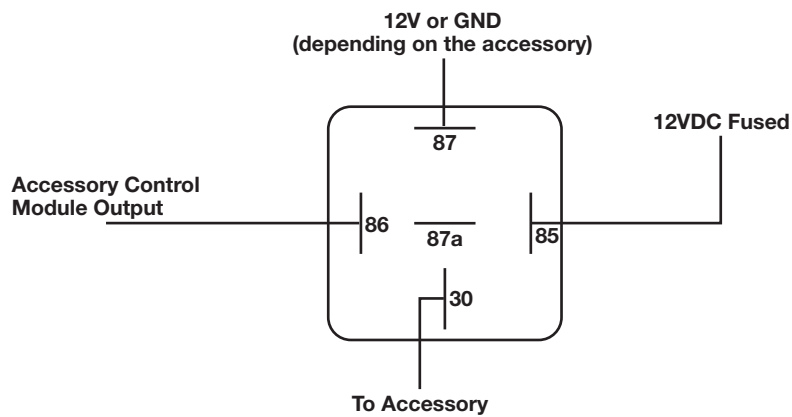

Head Unit Setting

In order to use this feature, the "External Accessory Control" setting must be turned on.

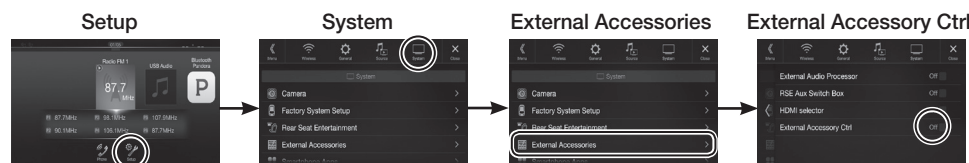

Please refer to the head unit's owner's manual for detailed operating instructions.

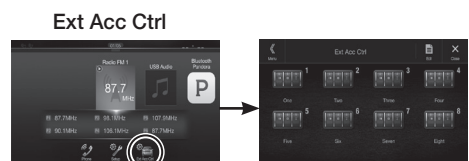

LIMITED WARRANTY

ALPINE ELECTRONICS OF AMERICA, INC. ("Alpine"), is dedicated to quality craftsmanship and is pleased to offer this Warranty. We suggest that you read it thoroughly. Should you have any questions, please contact your Dealer or contact Alpine at one of the telephone numbers listed below.

- **PRODUCTS COVERED:**
This Warranty covers Car Audio Accessories ("the product"). Products purchased in the Canada are covered only in the Canada. Products purchased in the U.S.A. are covered only in the U.S.A.
- **LENGTH OF WARRANTY:**
This Warranty is in effect for one year from the date of the first consumer purchase.
- **WHO IS COVERED:**
This Warranty only covers the original purchaser of the product, who must reside in the United States, Puerto Rico or Canada.
- **WHAT IS COVERED:**
This Warranty covers defects in materials or workmanship (parts and labor) in the product.
- **WHAT IS NOT COVERED:**
This Warranty does not cover the following:
 ① Damage occurring during shipment of the product to Alpine for repair (claims must be presented to the carrier).
 ② Damage caused by accident or abuse.
 ③ Damage caused by negligence, misuse, improper operation or failure to follow instructions contained in the Owner's manual.
 ④ Damage caused by act of God, including without limitation, earthquake, fire, flood, storms or other acts of nature. Any cost or expense related to the removal or reinstallation of the product.
 ⑤ Service performed by an unauthorized person, company or association.
 ⑥ Any product which has the serial number defaced, altered or removed.
 ⑦ Any product which has been adjusted, altered or modified without Alpine's consent.
 ⑧ Any product not distributed by Alpine within the United States, Puerto Rico or Canada.
 ⑨ **Any product not purchased from an Authorized Alpine Dealer.**
- **HOW TO OBTAIN WARRANTY SERVICE:**
 ① You are responsible for delivery of the product to an Authorized Alpine Service Center or Alpine for repair and for payment of any initial shipping charges. Alpine will, at its option, repair or replace the product with a new or reconditioned product without charge. If the repairs are covered by the warranty, and if the product was shipped to an Authorized Alpine Service Center or Alpine, Alpine will pay the return shipping charges.
 ② You should provide a detailed description of the problem(s) for which service is required.
 ③ You must supply proof of your purchase of the product.
- ④ You must package the product securely to avoid damage during shipment. To prevent lost packages it is recommended to use a carrier that provides a tracking service.
- **HOW WE LIMIT IMPLIED WARRANTIES:**
ANY IMPLIED WARRANTIES INCLUDING FITNESS FOR USE AND MERCHANTABILITY ARE LIMITED IN DURATION TO THE PERIOD OF THE EXPRESS WARRANTY SET FORTH ABOVE AND NO PERSON IS AUTHORIZED TO ASSUME FOR ALPINE ANY OTHER LIABILITY IN CONNECTION WITH THE SALE OF THE PRODUCT.
- **HOW WE EXCLUDE CERTAIN DAMAGES:**
ALPINE EXPRESSLY DISCLAIMS LIABILITY FOR INCIDENTAL AND CONSEQUENTIAL DAMAGES CAUSED BY THE PRODUCT. THE TERM "INCIDENTAL DAMAGES" REFERS TO EXPENSES OF TRANSPORTING THE PRODUCT TO THE ALPINE SERVICE CENTER, LOSS OF THE ORIGINAL PURCHASER'S TIME, LOSS OF THE USE OF THE PRODUCT, BUS FARES, CAR RENTALS OR OTHER COSTS RELATING TO THE CARE AND CUSTODY OF THE PRODUCT. THE TERM "CONSEQUENTIAL DAMAGES" REFERS TO THE COST OF REPAIRING OR REPLACING OTHER PROPERTY WHICH IS DAMAGED WHEN THIS PRODUCT DOES NOT WORK PROPERLY. THE REMEDIES PROVIDED UNDER THIS WARRANTY ARE EXCLUSIVE AND IN LIEU OF ALL OTHERS.
- **HOW STATE/PROVINCIAL LAW RELATES TO THE WARRANTY:**
This Warranty gives you specific legal rights, and you may also have other rights which vary from state to state and province to province. In addition, some states/provinces do not allow limitations on how long an implied warranty lasts, and some do not allow the exclusion or limitation of incidental or consequential damages. Accordingly, limitations as to these matters contained herein may not apply to you.
- **IN CANADA ONLY:**
This Warranty is not valid unless your Alpine car audio product has been installed in your vehicle by an Authorized Installation Center, and this warranty stamped upon installation by the installation center.
- **HOW TO CONTACT CUSTOMER SERVICE:**
Should the product require service, please call the following number for your nearest Authorized Alpine Service Center.
CUSTOMER SERVICE 1-800-421-2284, ext. 860304
TECH SUPPORT 1-800-TECH-101 (1-800-832-4101)
 Or visit our website at; <http://www.alpine-usa.com>

ALPINE ELECTRONICS OF AMERICA, INC., 19145 Gramercy Place, Torrance, California 90501, U.S.A.
 Do not send products to this address.
 Call the toll free telephone number or visit the website to locate a service center.