

T24UC915DS

UNDER-COUNTER DOUBLE DRAWER REFRIGERATOR / FREEZER

MASTERPIECE® SERIES HANDLE



Also Available:
 T24UC925DS – With Professional Series Handle
 T24UC905DP – Custom Panel-Ready

FEATURES & BENEFITS

- Customizable cooling modes in refrigerator drawer — Refrigerator, Pantry, Bar and Quick Chill
- SoftClose® drawers for ultra-smooth closing
- Customizable drawer dividers and shelving
- Filtered Automatic Ice Maker
- LED Lighting
- Drawer mats keep items from sliding and remove for easy cleaning
- Touch electronic controls for temperature management

GENERAL PROPERTIES

| | |
|---|--------------|
| SoftClose® Drawers | Yes |
| Lighting | LED Lighting |
| Customizable Aluminum Dividers / Shelving | Yes |
| Removable Drawer Mats | Yes |
| Filtered Automatic Ice Maker | Yes |
| Full Extension Drawers | Yes |
| Drawer Open Alarm | Yes |
| Quick Chill | Yes |
| Touch Electronic Controls | Yes |
| STAR-K Certified Sabbath Mode | Yes |

CAPACITY

| | |
|--------------------------|-------------|
| Total Capacity (cu. ft.) | 4.3 cu. ft. |
|--------------------------|-------------|

TEMPERATURE RANGES

| | |
|-----------------------|---|
| Refrigerator | 33°F (0.5°C) to 47°F (8.5°C) |
| Freezer | -8°F (-22°C) to 6°F (-14.5°C) |
| Pre-Set Cooling Modes | Refrigerator 37°F (3°C) Pantry 44°F (7°C) Bar 34°F (1°C) |
| Quick Chill | Refrigerator 33°F (0.5°C) for approximately 24 hours Freezer -8°F (-22°C) for approximately 24 hours |

TECHNICAL DETAILS

| | |
|-------------------------------------|------------------------|
| Watts (W) / Current (A) / Volts (V) | 150 W / 15 Amp / 115 V |
| Frequency (Hz) | 60 Hz |
| Power Cord Length (in.) | 60" |
| Plug Type | 120V 3-Wire |

DIMENSIONS & WEIGHT

| | |
|--|------------------------------|
| Appliance Dimensions (H x W x D) (in.) | 34 1/8"* x 23 7/8" x 23 5/8" |
| Required Cutout Size (H x W x D) (in.) | 34 1/2"–35 1/8" x 24" x 24" |
| Net / Gross Weight (lbs.) | 144.5 / 155.5 lbs. |

EFFICIENCY

| | |
|---------------------------|---------|
| ENERGY STAR® Qualified | Yes |
| Annual Energy Consumption | 442 kWh |

WARRANTY

Limited, Entire Appliance, Parts and Labor on any Part of the Refrigerator that Fails Because of a Manufacturing Defect

2 Year

Limited Warranty for Sealed Refrigeration System*; Parts and Labor
 3rd to 6th Year

Limited Warranty for Sealed Refrigeration System*; Parts Only
 7th to 12th Year

*Height adjustable + 1/2" (13 mm) with legs fully extended

**Sealed refrigeration system includes compressor, evaporator, condenser, dryer / strainer and connection tubing

T24UC915DS

UNDER-COUNTER DOUBLE DRAWER REFRIGERATOR / FREEZER

MASTERPIECE® SERIES HANDLE



DOUBLE DRAWER REFRIGERATOR / FREEZER PRODUCT DIMENSIONS

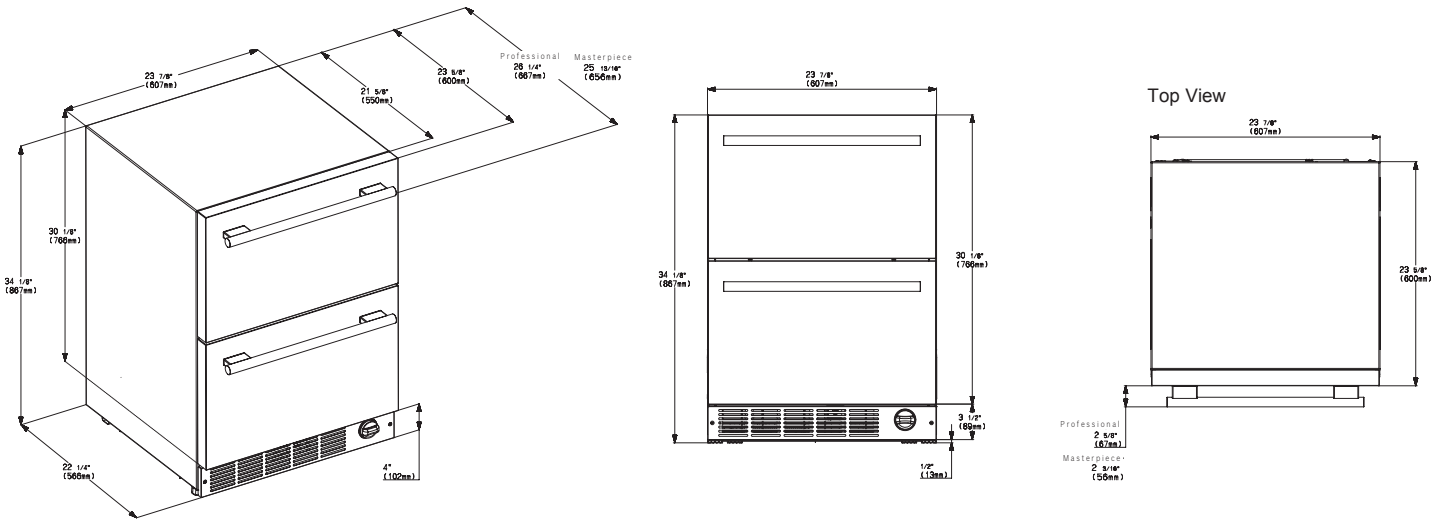

DOUBLE DRAWER REFRIGERATOR / FREEZER CUTOUT DIMENSIONS

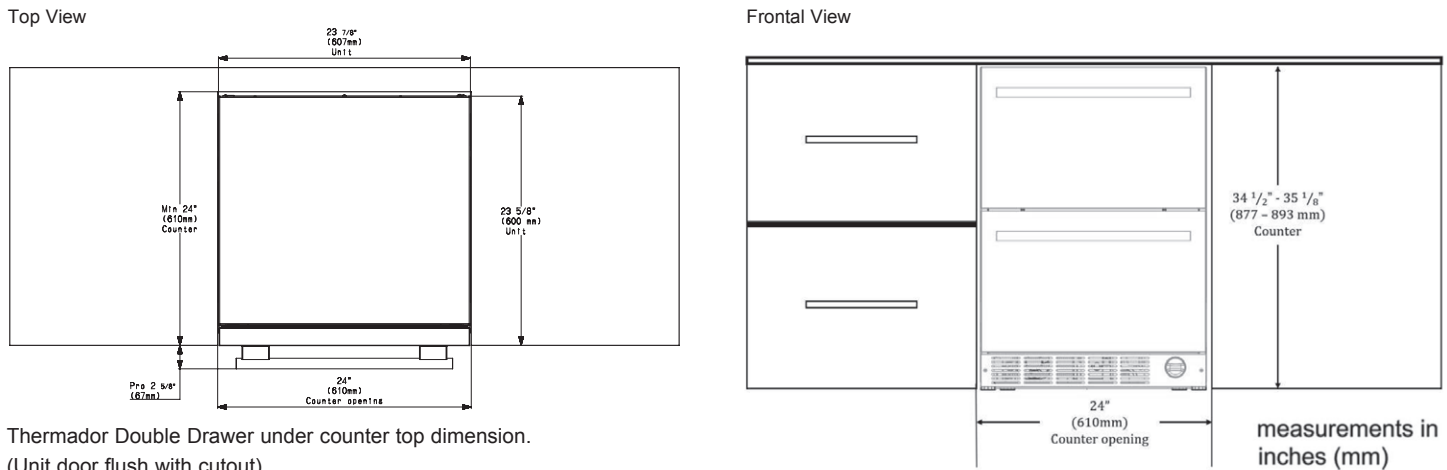

Thermador Double Drawer under counter top dimension.
(Unit door flush with cutout)

DOUBLE DRAWER REFRIGERATOR / FREEZER CLEARANCE DIMENSIONS

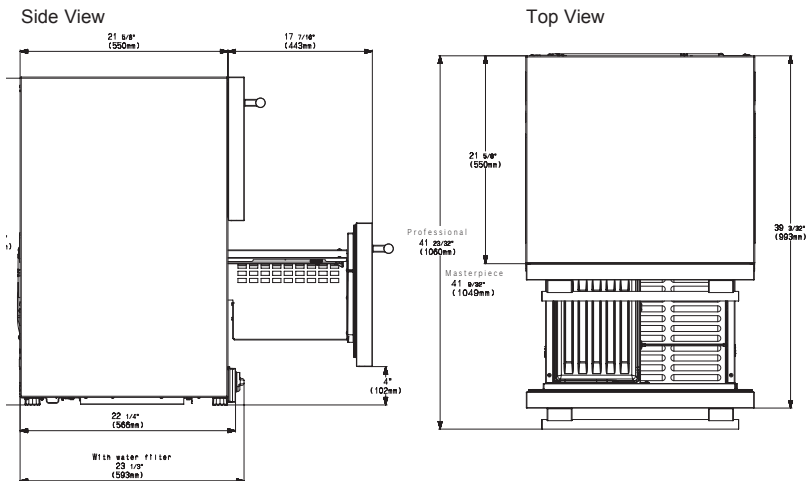

ACCESSORIES (OPTIONAL)

FILTERS



UCTRFLTR10
Water Filter

T24UC915DS

UNDER-COUNTER DOUBLE DRAWER REFRIGERATOR / FREEZER

MASTERPIECE® SERIES HANDLE



DOUBLE DRAWER REFRIGERATOR / FREEZER SIDE-BY-SIDE INSTALLATION

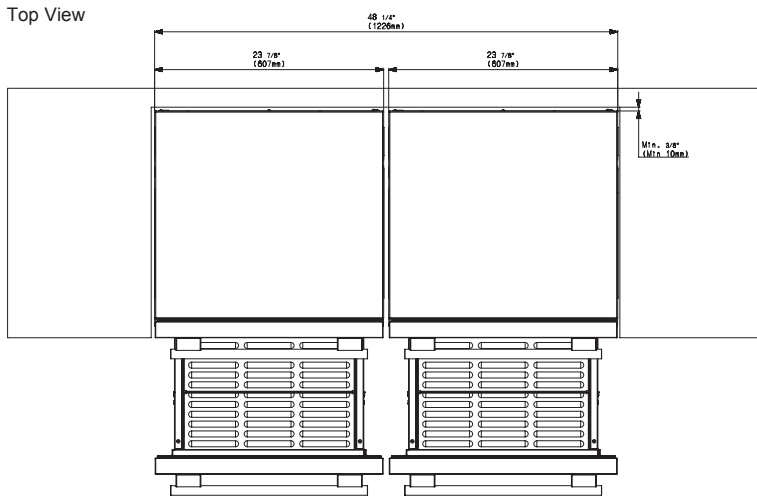

DOUBLE DRAWER REFRIGERATOR / FREEZER CUTOUT DIMENSIONS & ELECTRICAL LOCATION

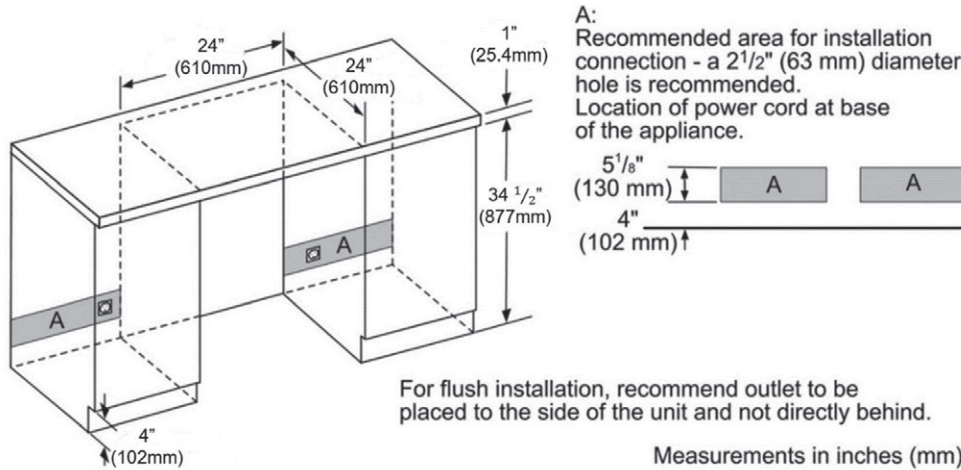

These warranties give you specific legal rights and you may have other rights that vary from state to state. Limited warranty from date of purchase. For complete warranty details, refer to your Use & Care manual, or ask your dealer.

Specifications are for planning purposes only. Refer to installation instructions and consult your countertop supplier prior to making counter opening. Consult with a heating and ventilation engineer for your specific ventilation requirements. For the most detailed information, refer to installation instructions accompanying product or write to Thermador indicating the model number. Specifications are correct at time of printing. Thermador reserves the right to change product specifications or design without notice. Some models are certified for use in Canada. Thermador is not responsible for products that are transported from the U.S. for use in Canada.