

Chest Freezer Handle Installation

Handle Installation

1. Remove the 4 screws with a Phillips Screwdriver.

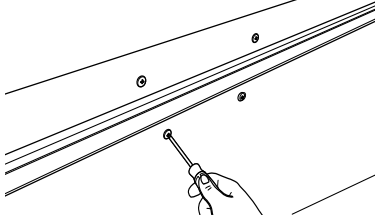

2. Set handles and screws on lid.

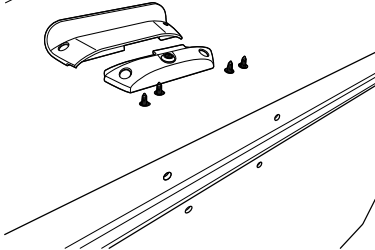

3. Install the upper assembly.

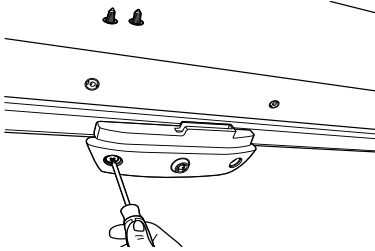

4. Install the lower assembly.

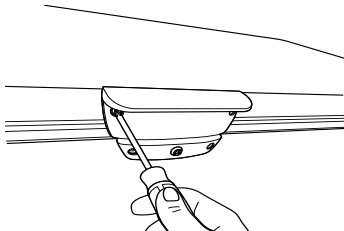

5. Screw cover has a little bump and a hole has a little recess.

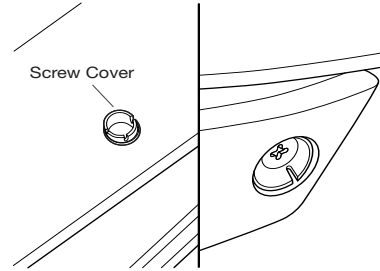

6. Install the 4 screw covers with bump going into the recess.

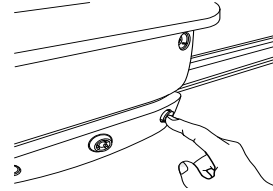

7. Handle Installation is complete.

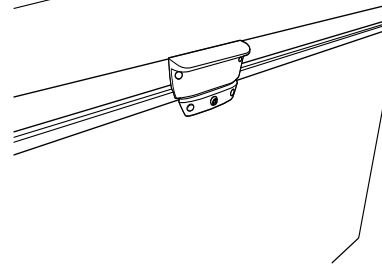

Installation de la poignée du congélateur horizontal

Installation de la poignée

1. Retirer les 4 vis à l'aide d'un tournevis à tête cruciforme.

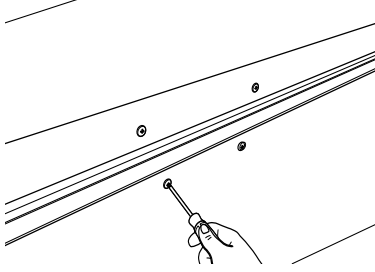

2. Mettre les poignées et les vis sur le couvercle.

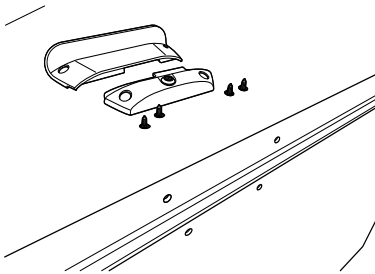

3. Installer l'ensemble supérieur.

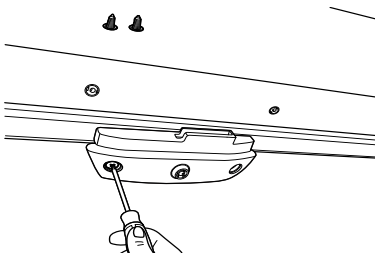

4. Installer l'ensemble inférieur.

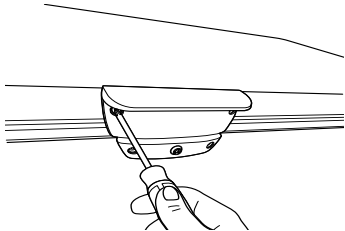

5. Le capot de vis comporte une petite bosse et le trou à vis comporte un petit retrait.

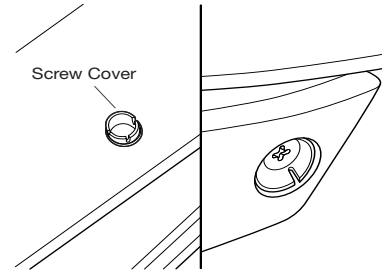

6. Installer les 4 vis avec capot et s'assurer que la bosse de chaque capot entre dans le retrait du trou à vis.

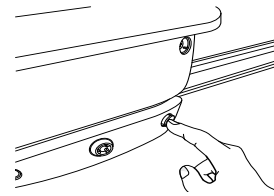

7. L'installation de la poignée est terminée.

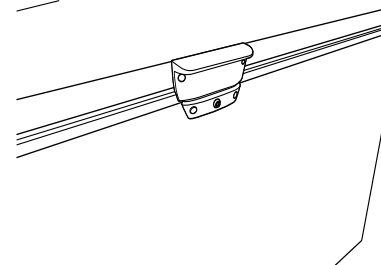

Instalación de la manija del congelador horizontal

Instalación de la manija

1. Quite los 4 tornillos con un destornillador Phillips.

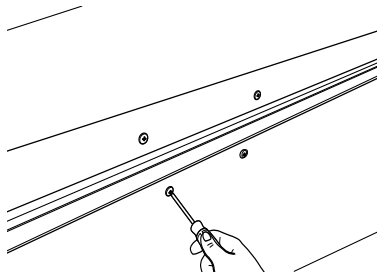

2. Coloque las manijas y los tornillos en la tapa.

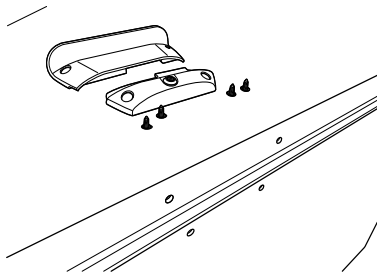

3. Instale la parte superior.

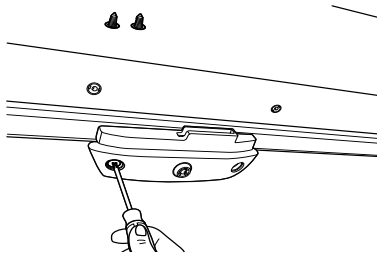

4. Instale la parte inferior.

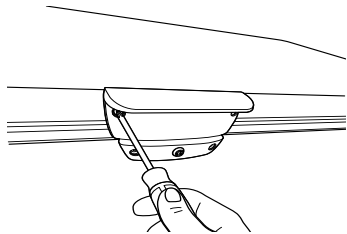

5. La cubierta del tornillo tiene una pequeña saliente y el orificio tiene una pequeña muesca.

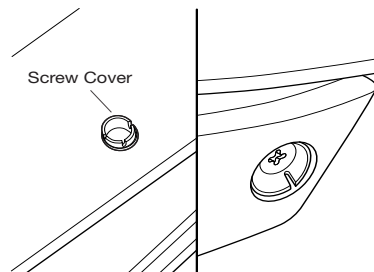

6. Instale las 4 cubiertas del tornillo y alinee la saliente con la muesca.

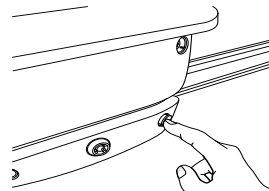

7. Se ha completado la instalación de la manija.

