

PERFEKT GLIDE 24-REC
24" Built-in Telescopic Range Hood

AEG

PERFEKT GLIDE 24-REC

24" Built-in Telescopic Range Hood



RANGE HOOD FEATURES

- 24" (60cm) stainless steel built-in glide-out range hood
- Recirculating
- LED lighting (3,200 Lumens)
- 2 speed adjustment
- 2 x dishwasher safe honey comb filters
- Electronic switch controls
- Quiet (7 sones/56dB) 300 CFM motor

DUCT SIZE

- 6" Duct Adapter Included

ELECTRICAL REQUIREMENTS

- 115 Volt, 60Hz, 15AMP
- AEG Range Hoods are supplied with a Canadian cord and plug
- Electrical cord located 3^{1/8"} (79mm) from the top right corner of the unit at the rear

Specifications

PERFEKT GLIDE 24-REC

RANGE HOOD DIMENSIONS

D: 11" x W: 23^{9/16}"

D: 280mm x W: 598mm

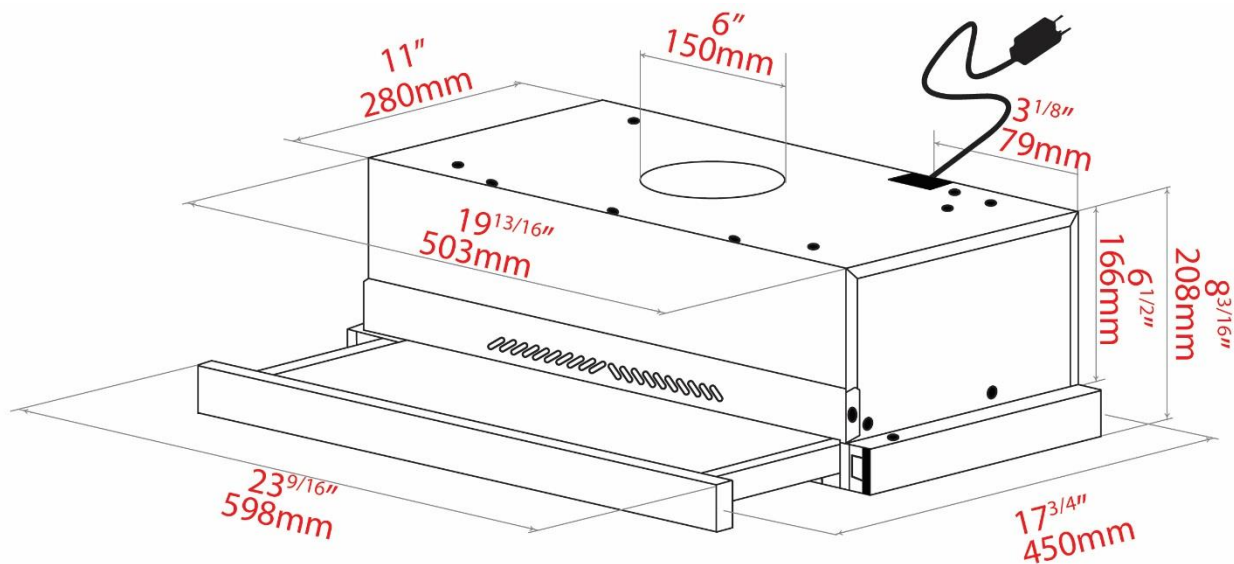

FRONT PANEL - DUCTED

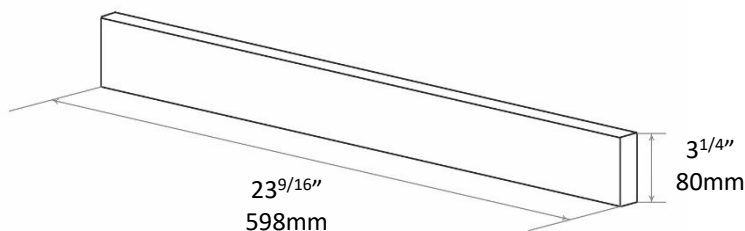

Specifications

PERFEKT GLIDE 24-REC

CABINET BOX DESIGN - (RECIRCULATING)

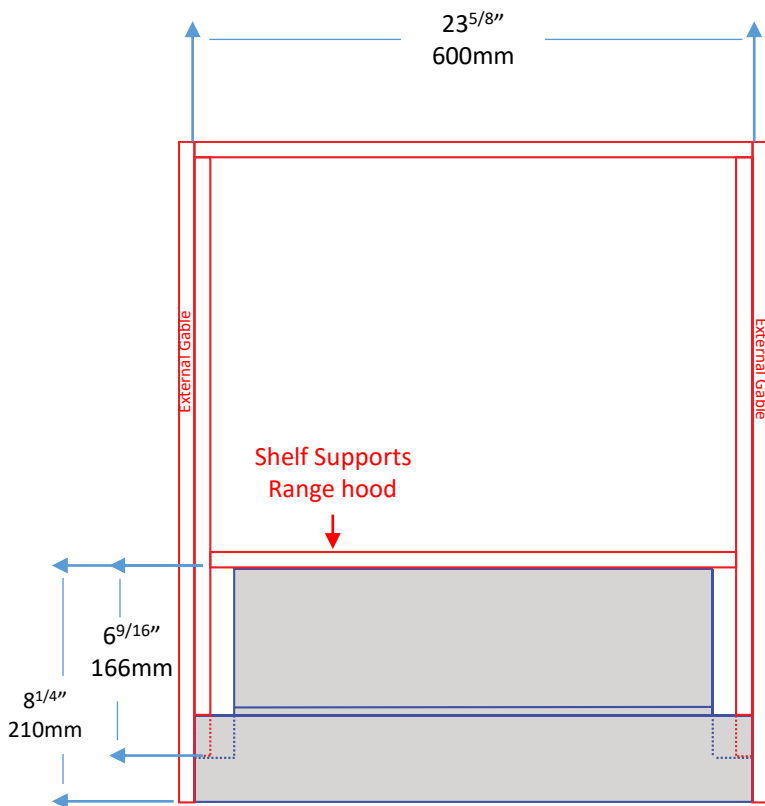

FRONT VIEW

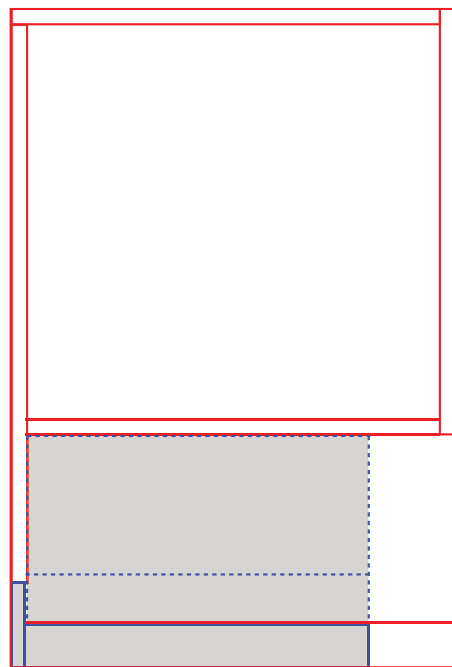

SIDE VIEW

PERFEKT GLIDE 24-REC

FRONT PANEL INSTALLATION

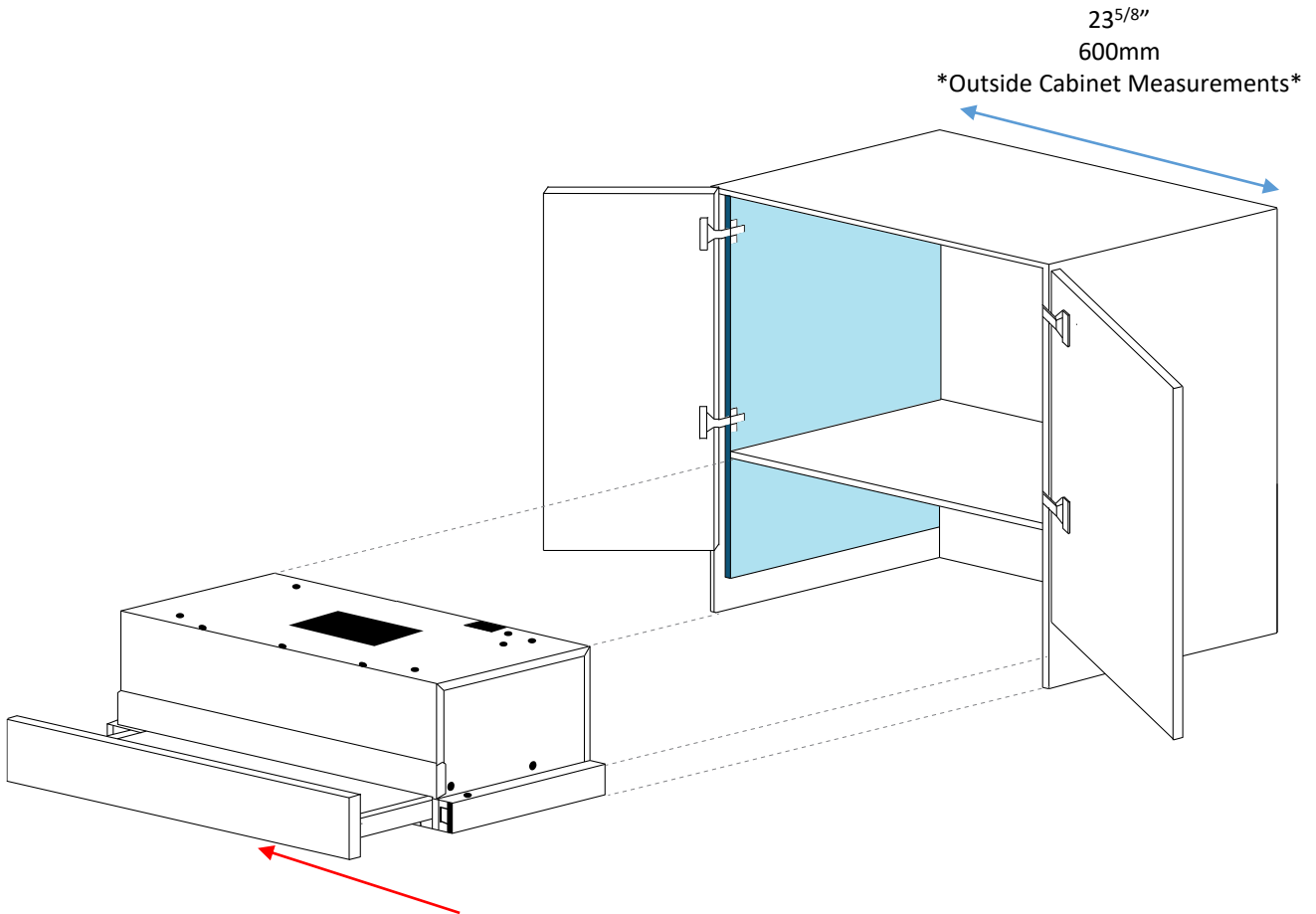

NOTE: Removing the front stainless steel trim

- 1. Pull the glide forward
- 2. Remove the 4 screws holding the glide to the panel
- 3. Install the matching front panel using the 4 screws

Custom panel provided by customer

PERFEKT GLIDE 24-REC

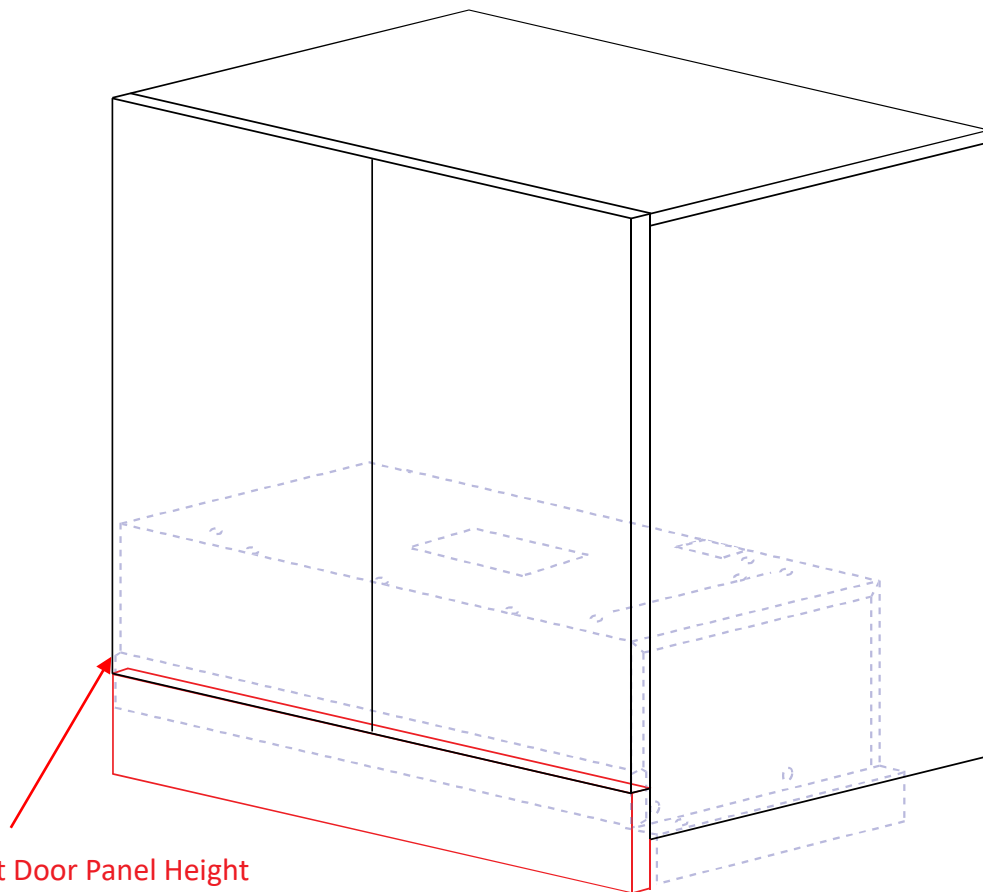

NOTE: Cabinet Door Panel Height

- Ensure that the cabinet door panel is shortened to accommodate the larger sized Range Hood Front Panel

PERFEKT GLIDE 24-REC

RECOMMENDED CABINET MINIMUM CLEARANCE GAS COOKING SURFACE

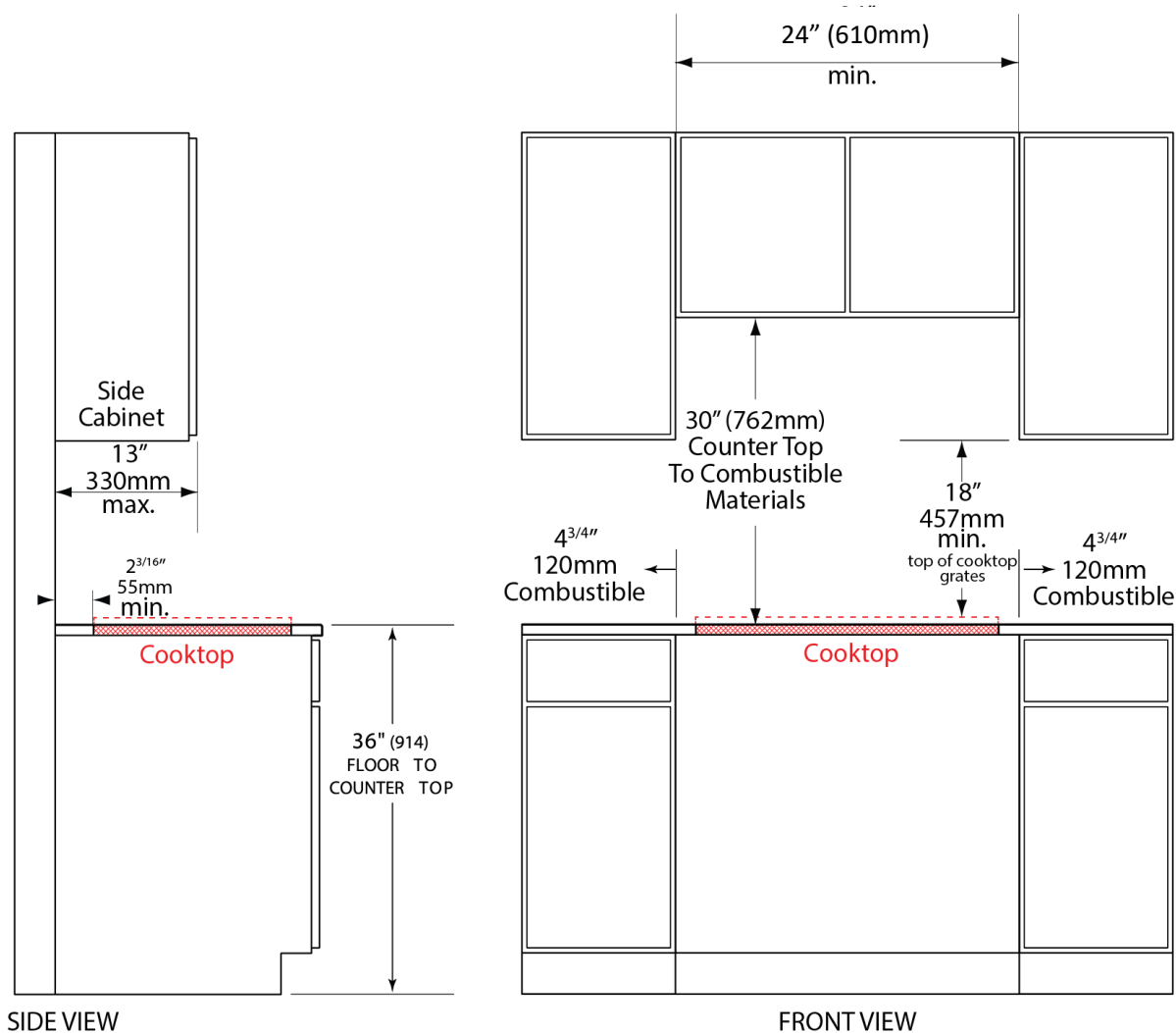

Specifications

PERFEKT GLIDE 24-REC

RECOMMENDED CABINET MINIMUM CLEARANCE (ELECTRIC / INDUCTION COOKING SURFACE)

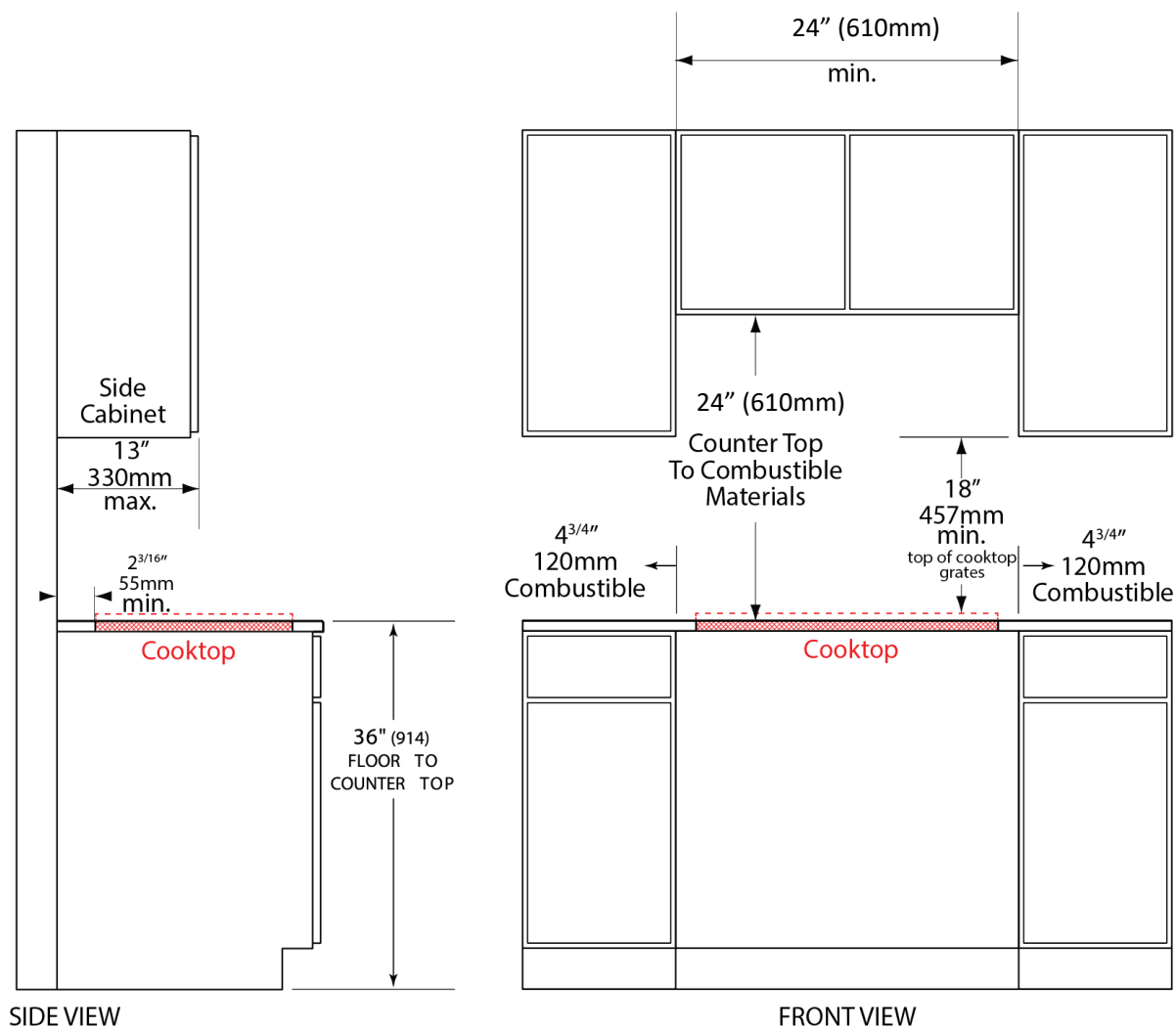



AEG Appliances are designed and manufactured to the highest standards.
Each appliance is covered by a comprehensive 2-year parts and labour warranty.

Refer to product warranty policy for complete terms and conditions.

FOR PARTS AND SERVICE

Euro-Parts & Service

39822 Belgrave Road, Belgrave, ON. N0G 1E0

1 800 678 8352 (Canada) • 1 800 561 4614 (U.S.)

www.euro-parts.ca • parts@euro-parts.ca • service@euro-parts.ca

AEG appliances are imported and distributed in North America by
Euro-Line Appliances Inc. For more information, please visit one of our showrooms or

www.ela.ca www.elawest.com

EURO-LINE APPLIANCES INC.

871 Cranberry Court
Oakville, ON L6L 6J7 Canada
905 829 3980
1 800 421 6332

marketing@euro-line-appliances.com

EURO-LINE APPLIANCES WEST INC.

101-1014 Homer Street
Vancouver, BC V6B 2W9 Canada
604 235 3980
1 855 ELA WEST (352 9378)

info@elawest.com

