

# Hall Tree Stand

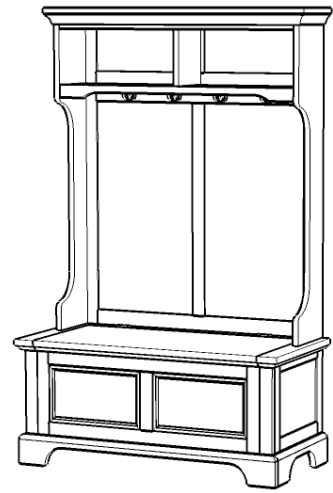

## IMPORTANT

Carefully remove all the parts from the carton and place them individually on a soft cloth to prevent scratches or other damage.

Carefully and strictly follow these assembly instructions to ensure a completed product as designed.

Do not use power tools above 8 volts to assemble.

## Part List

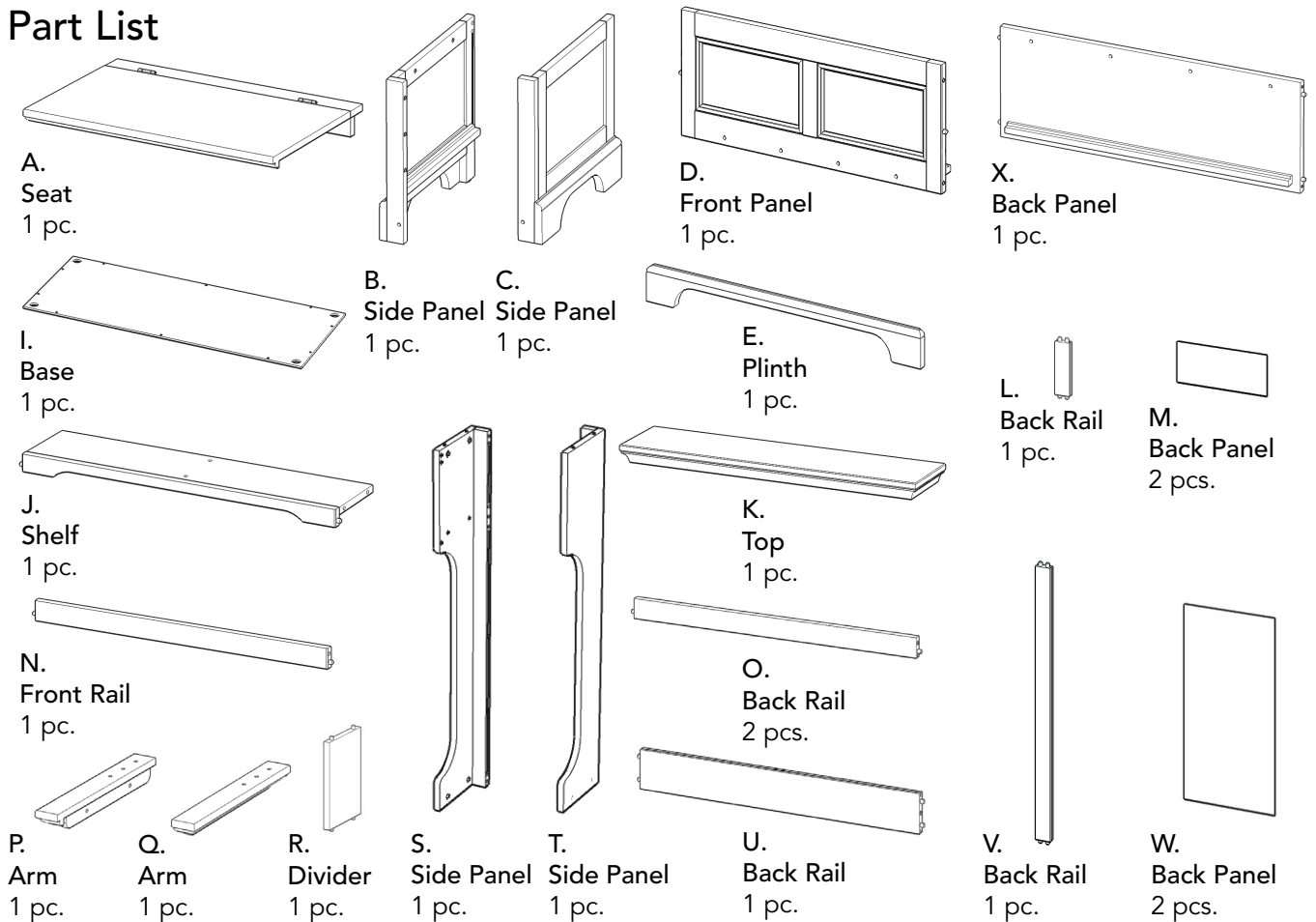

## Hardware List

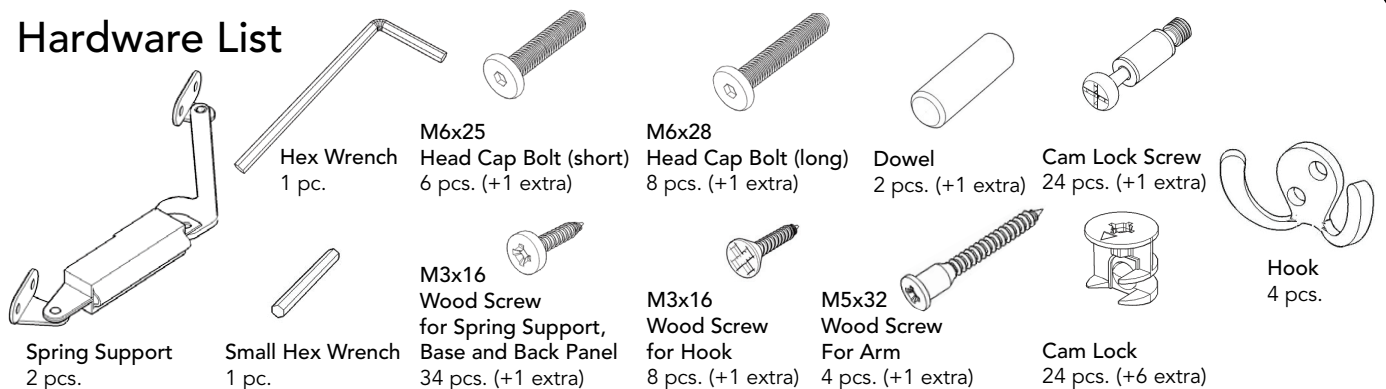

Tool(s) required for assembly: Phillips screwdriver, Level, Drill (8 volts or less), 3/8" Drill Bit

# Assembly Instructions 2/8

## IMPORTANT

- Use a soft cloth between these parts and the floor.
- Do not use power tools above 8 volts to assemble.
- Do not tighten all the bolts until each part is properly assembled.
- Keep Hex Wrench in a safe place as the bolts may need to be tightened up in the future.

## STEP 1

Insert Cam Lock Screws into pre-drilled holes of Side Panels (B), (C), (S), (T) and Top (K), then tighten. (See Figure 1)

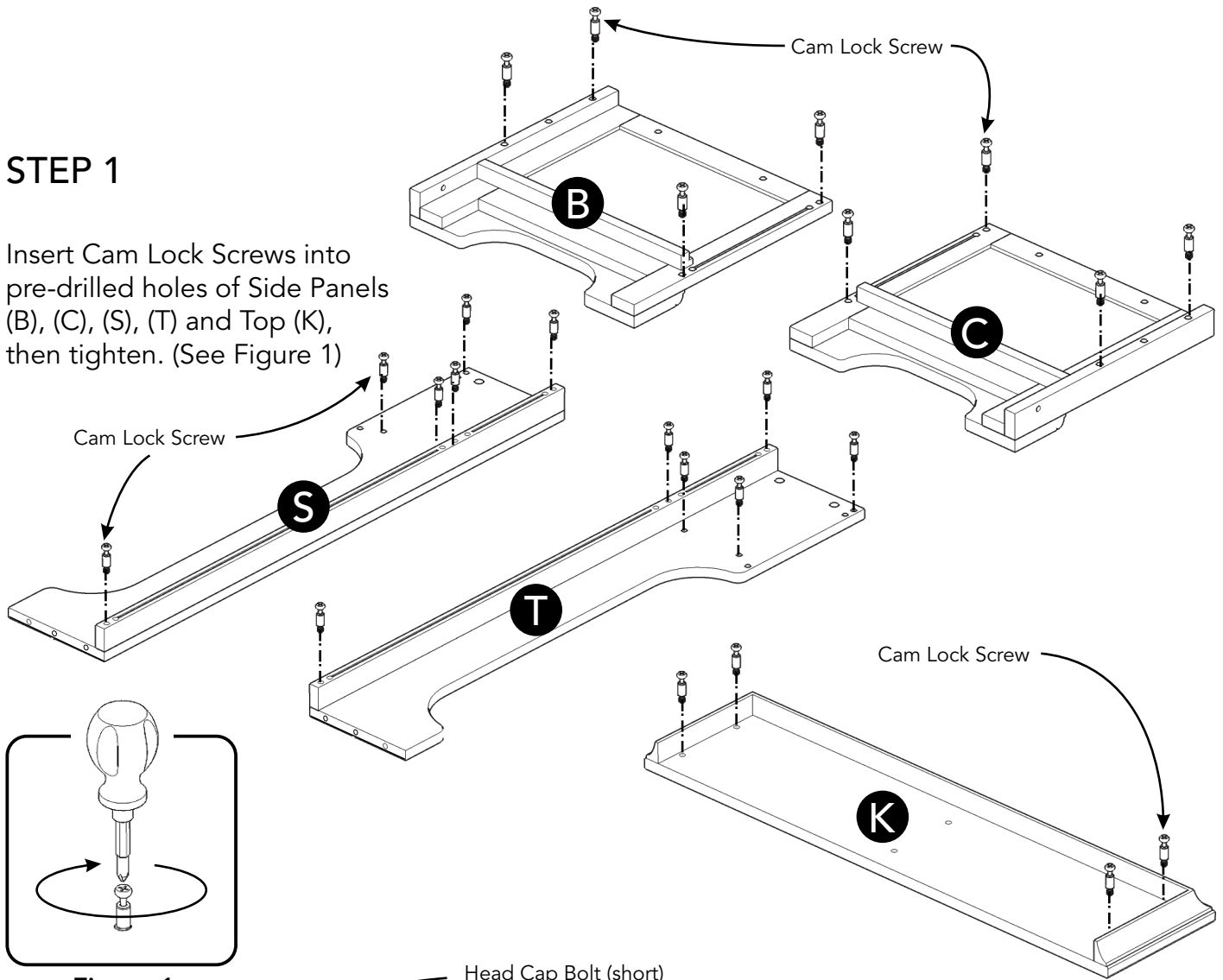

Figure 1

## STEP 2

Attach Front Panel (D) to Plinth (E) with Head Cap Bolts (short). (See Figure 2)

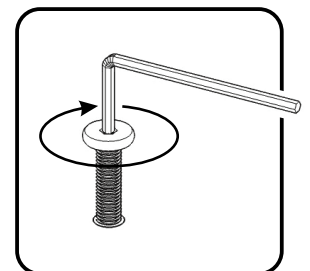
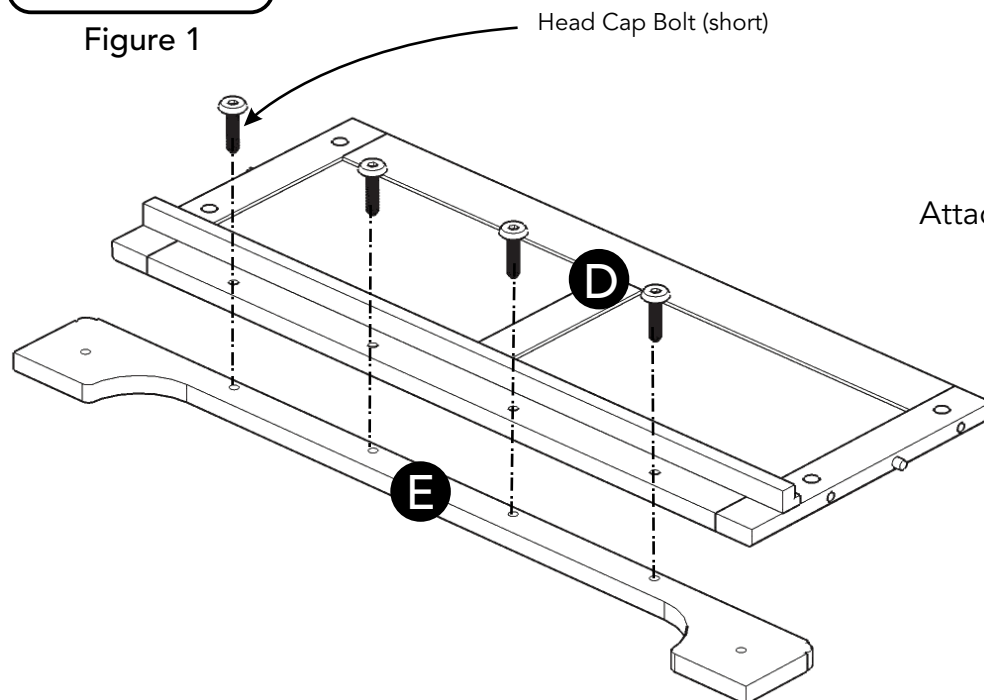
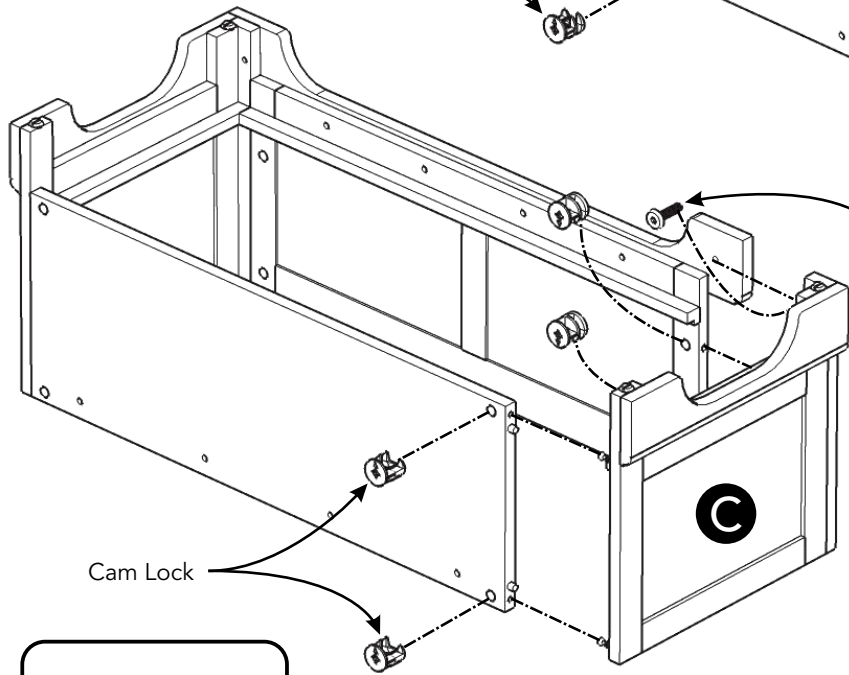
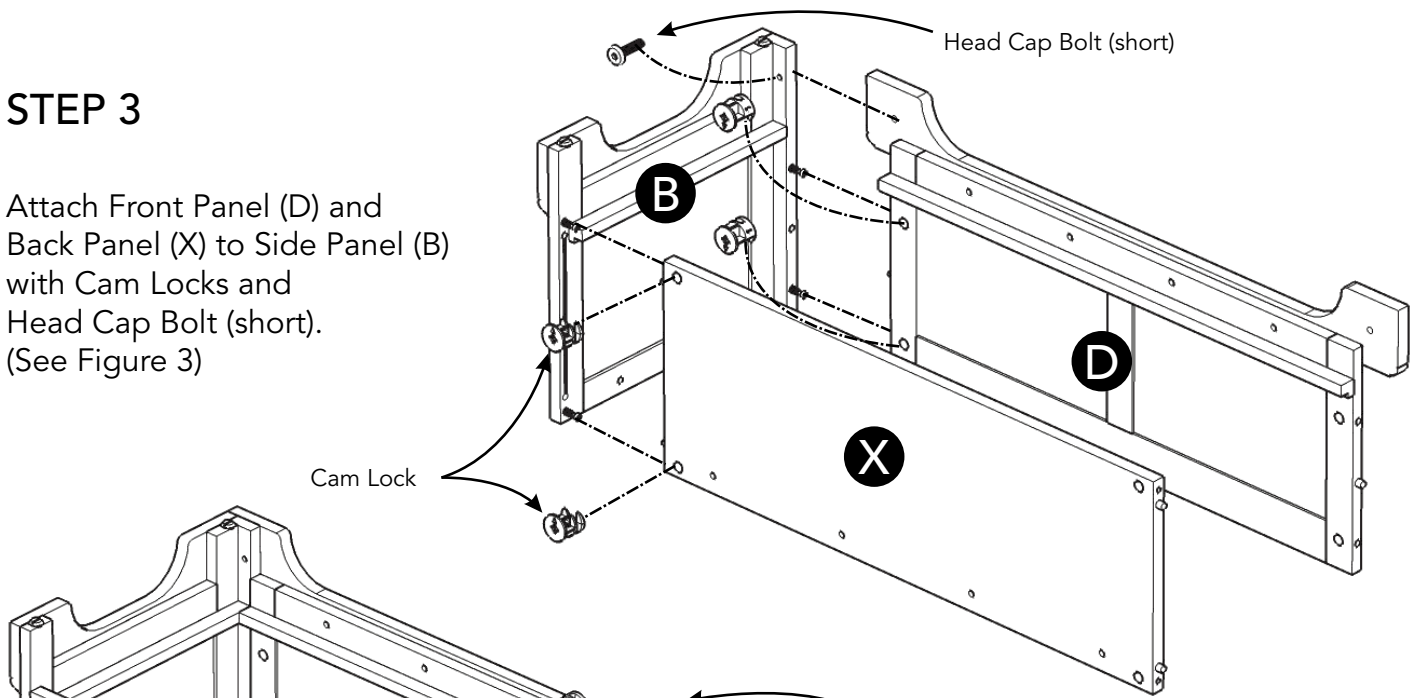

Figure 2

# Assembly Instructions 3/8

## STEP 3

Attach Front Panel (D) and Back Panel (X) to Side Panel (B) with Cam Locks and Head Cap Bolt (short). (See Figure 3)



## STEP 4

Attach Side Panel (C) to unit with Cam Locks and Head Cap Bolt (short).

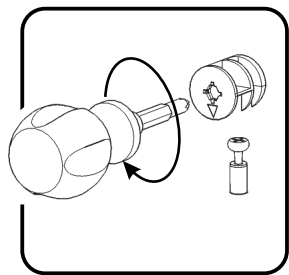

Figure 3

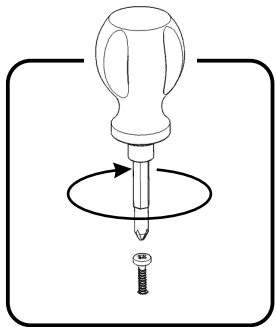
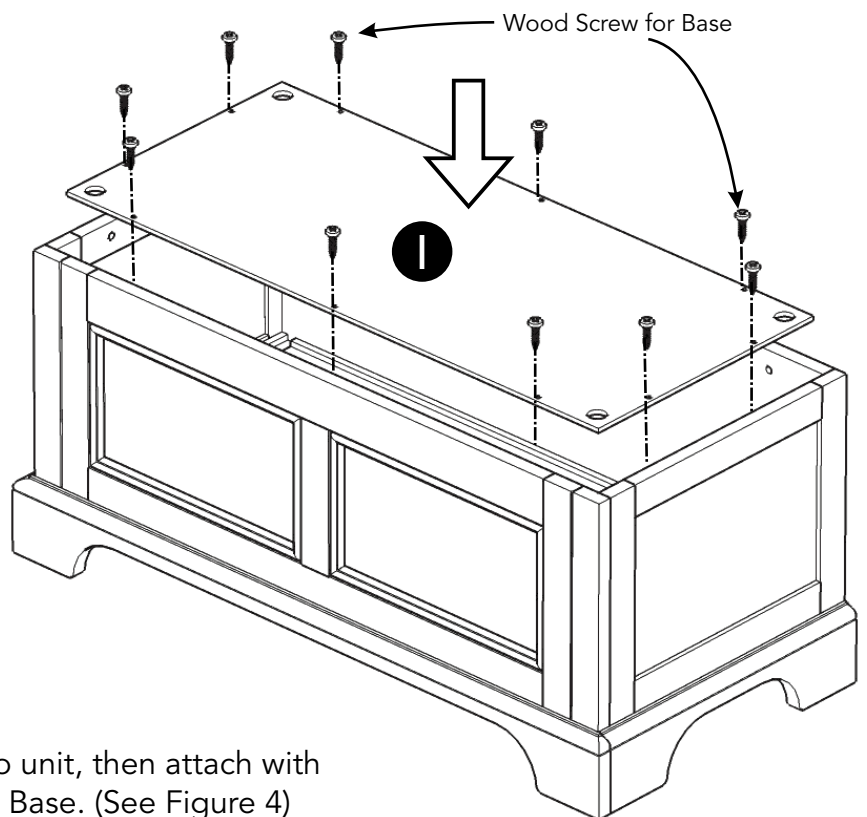

Figure 4



## STEP 5

Insert Base (I) into unit, then attach with Wood Screws for Base. (See Figure 4)

## Assembly Instructions 4/8

### STEP 6

Attach Spring Supports to Seat (A) by inserting Wood Screws for Spring Support into pre-drilled holes, then tighten. (See Figure 5)

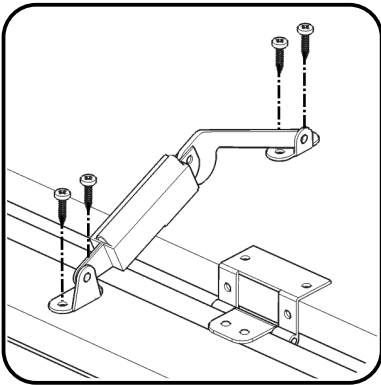
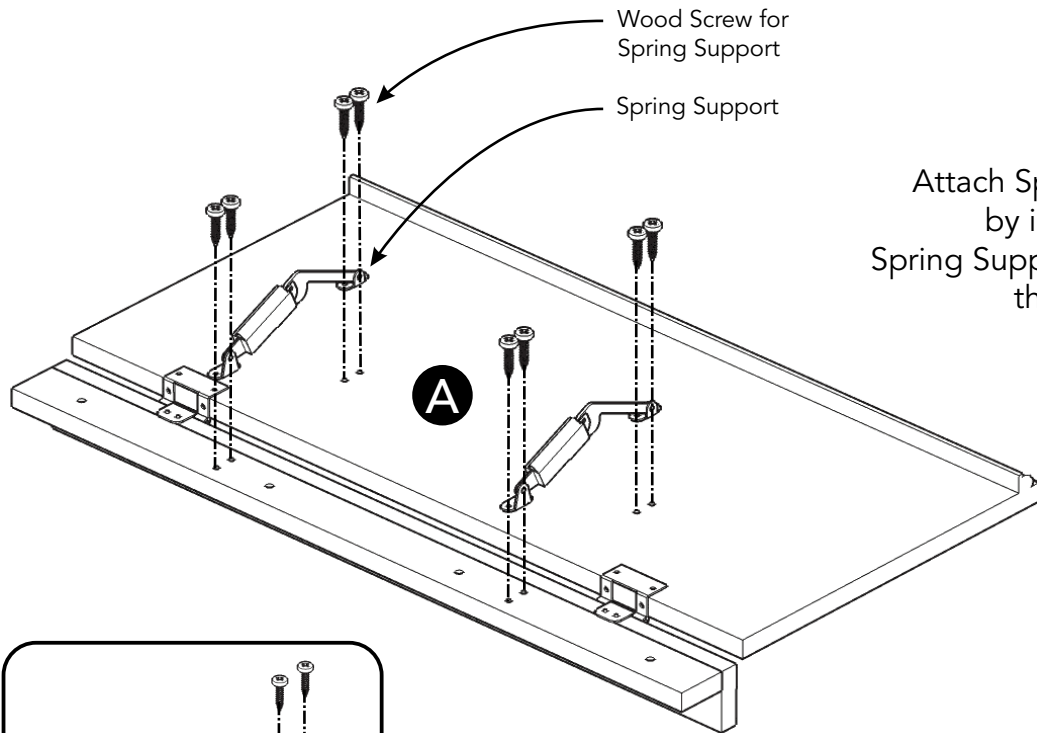
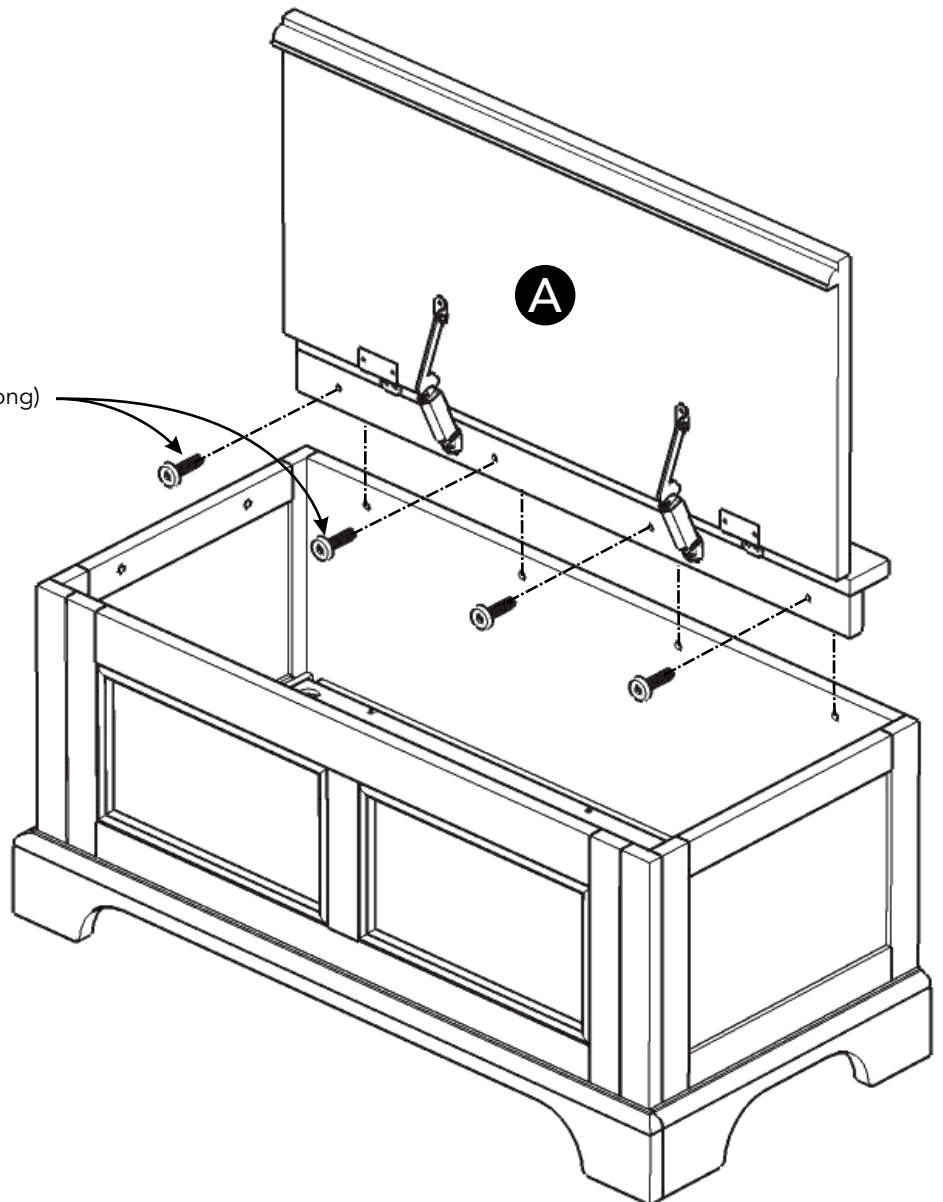

Figure 5

Head Cap Bolt (long)



### STEP 7

Attach Seat (A) to unit with Head Cap Bolts.

# Assembly Instructions 5/8

## STEP 8

Attach Hooks to Back Rail (U) with Wood Screws for Hook.  
(See Figure 6)

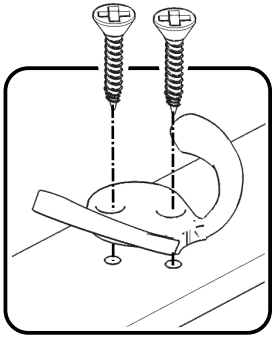
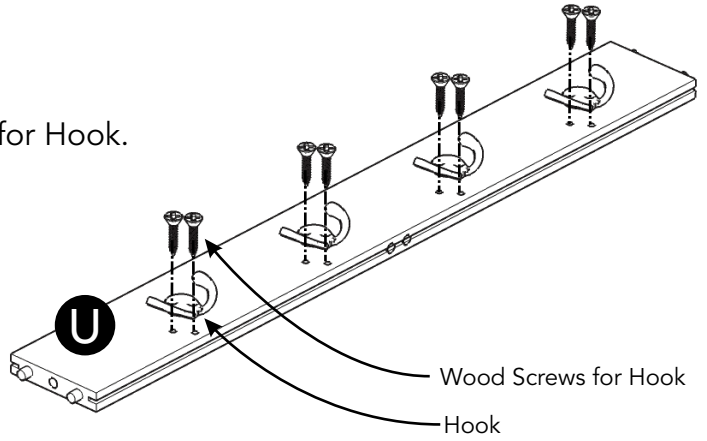
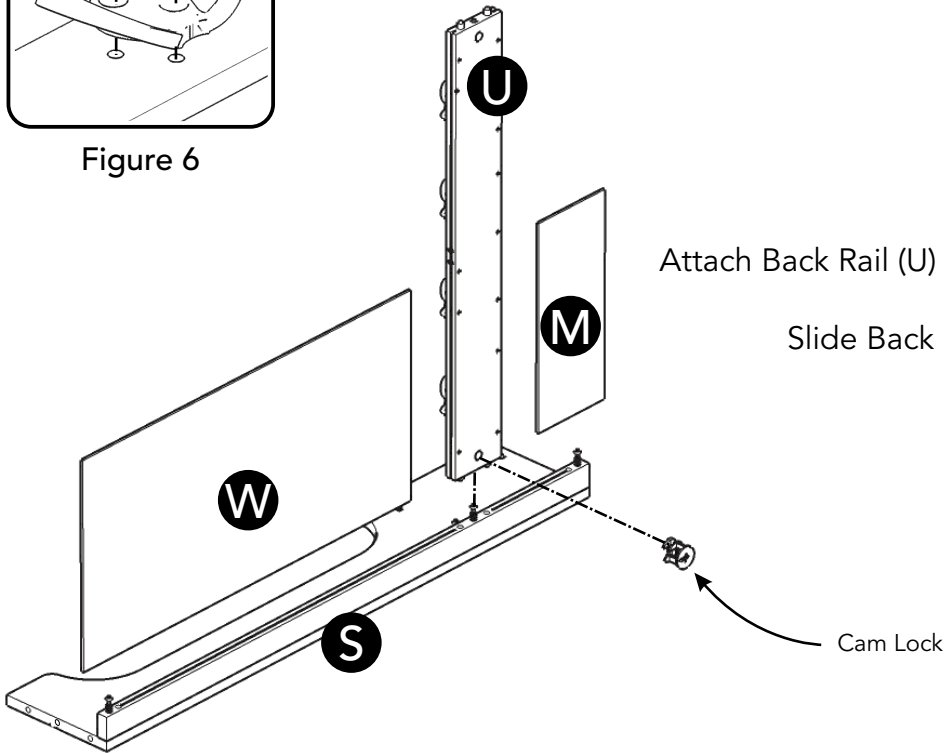

Figure 6



## STEP 9

Attach Back Rail (U) to Side Panel (S) with Cam Lock.  
Slide Back Panels (M) and (W) into position.



## STEP 10

Attach Back Rails (L) and (V) to unit.

Attach Back Rails (O) to unit with Cam Locks.

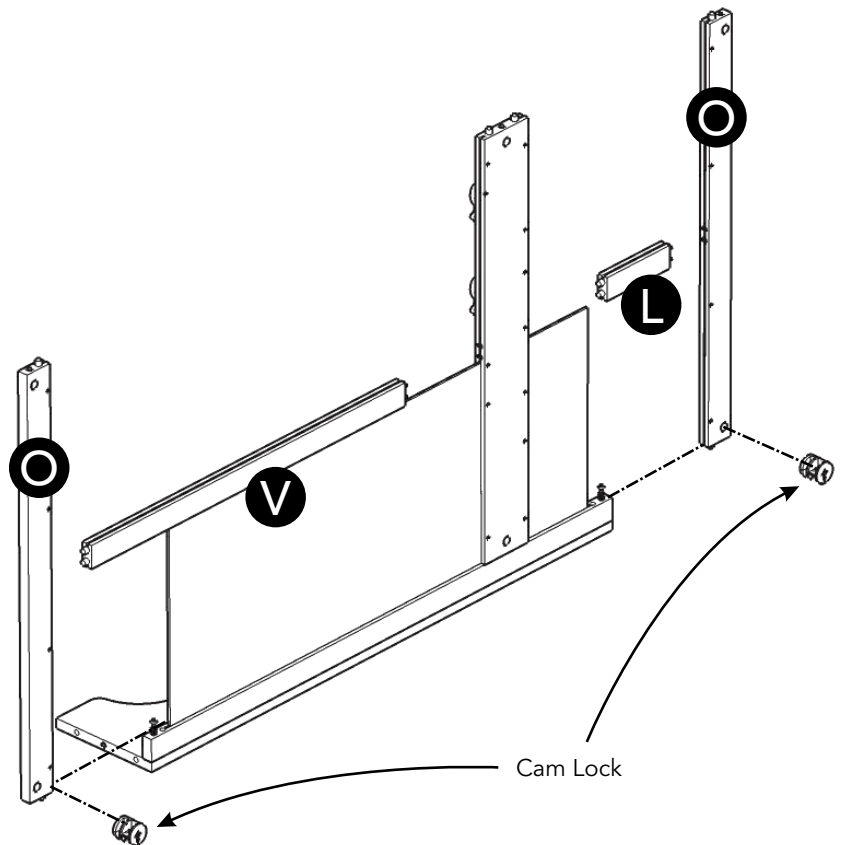

## Assembly Instructions 6/8

### STEP 11

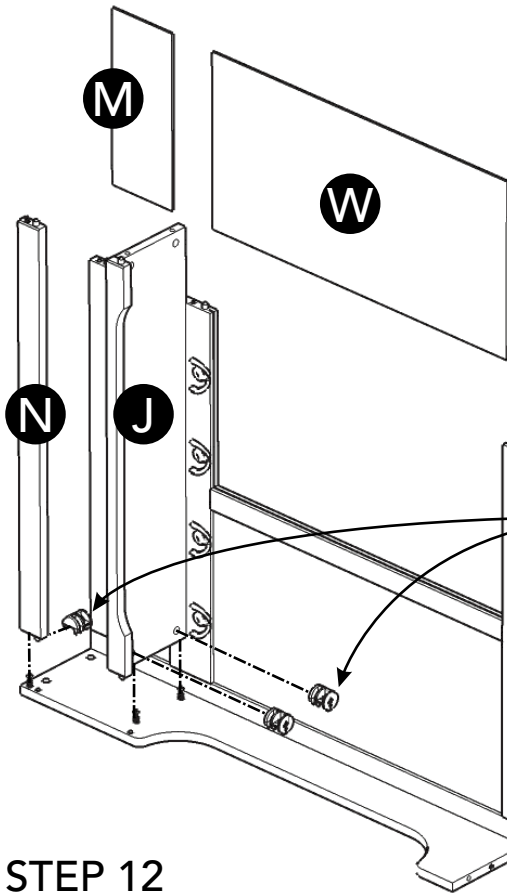

Attach Shelf (J) and Front Rail (N) to unit with Cam Locks.

Slide Back Panels (M) and (W) into position.

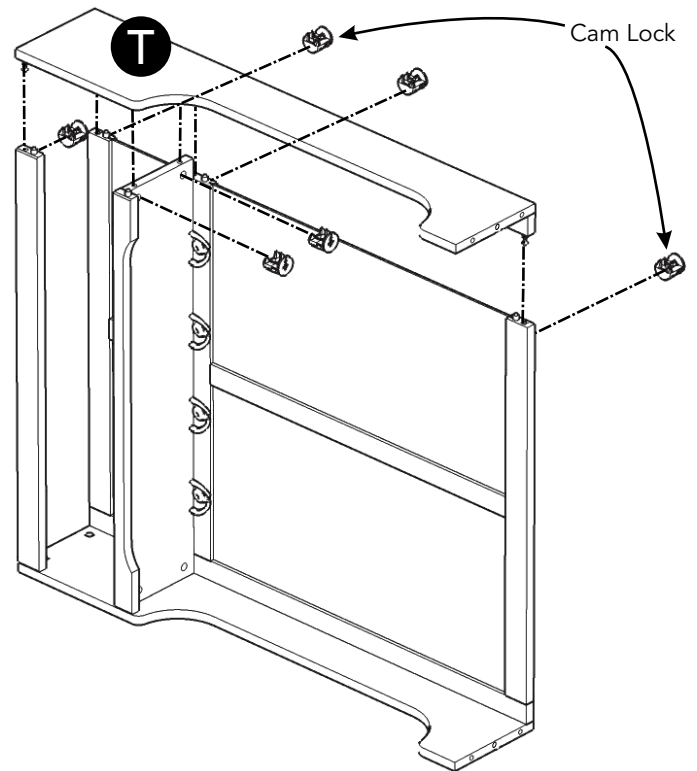

### STEP 12

Attach Side Panel (T) to unit with Cam Locks.

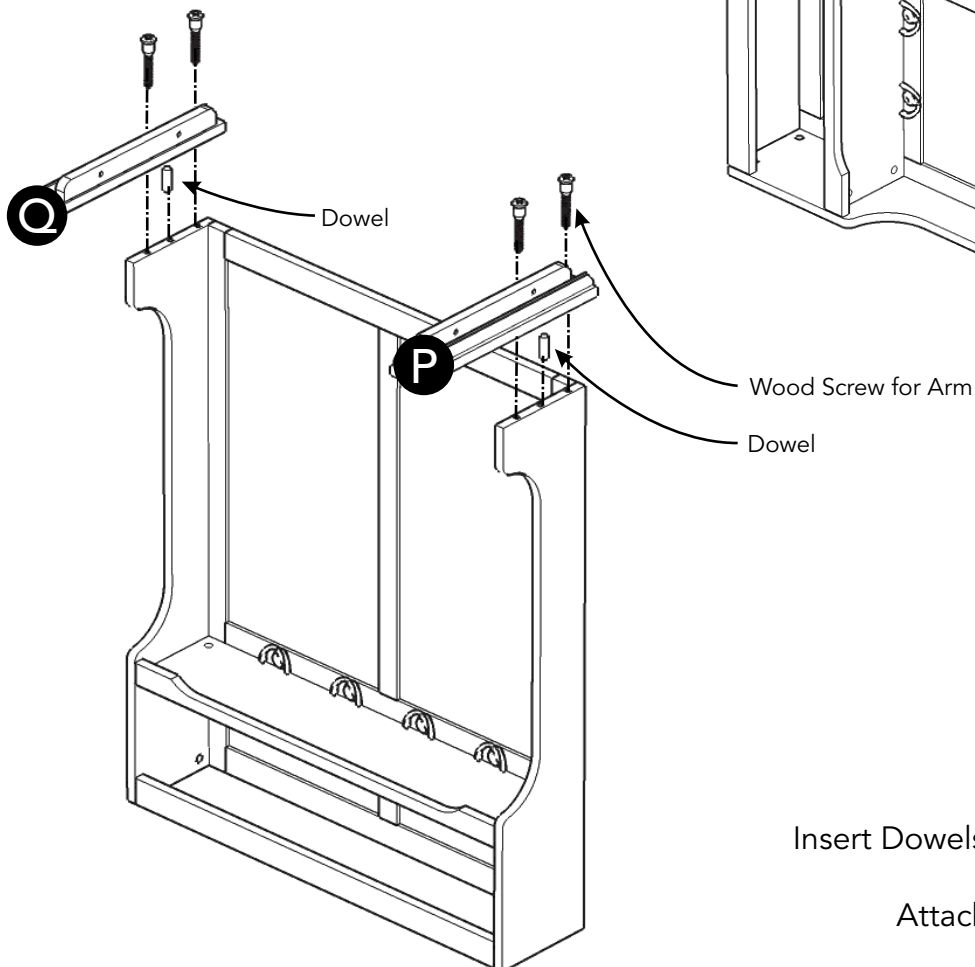

### STEP 13

Insert Dowels into pre-drilled holes of unit.

Attach Arms (P) and (Q) to unit with Wood Screws for Arm.



## STEP 14

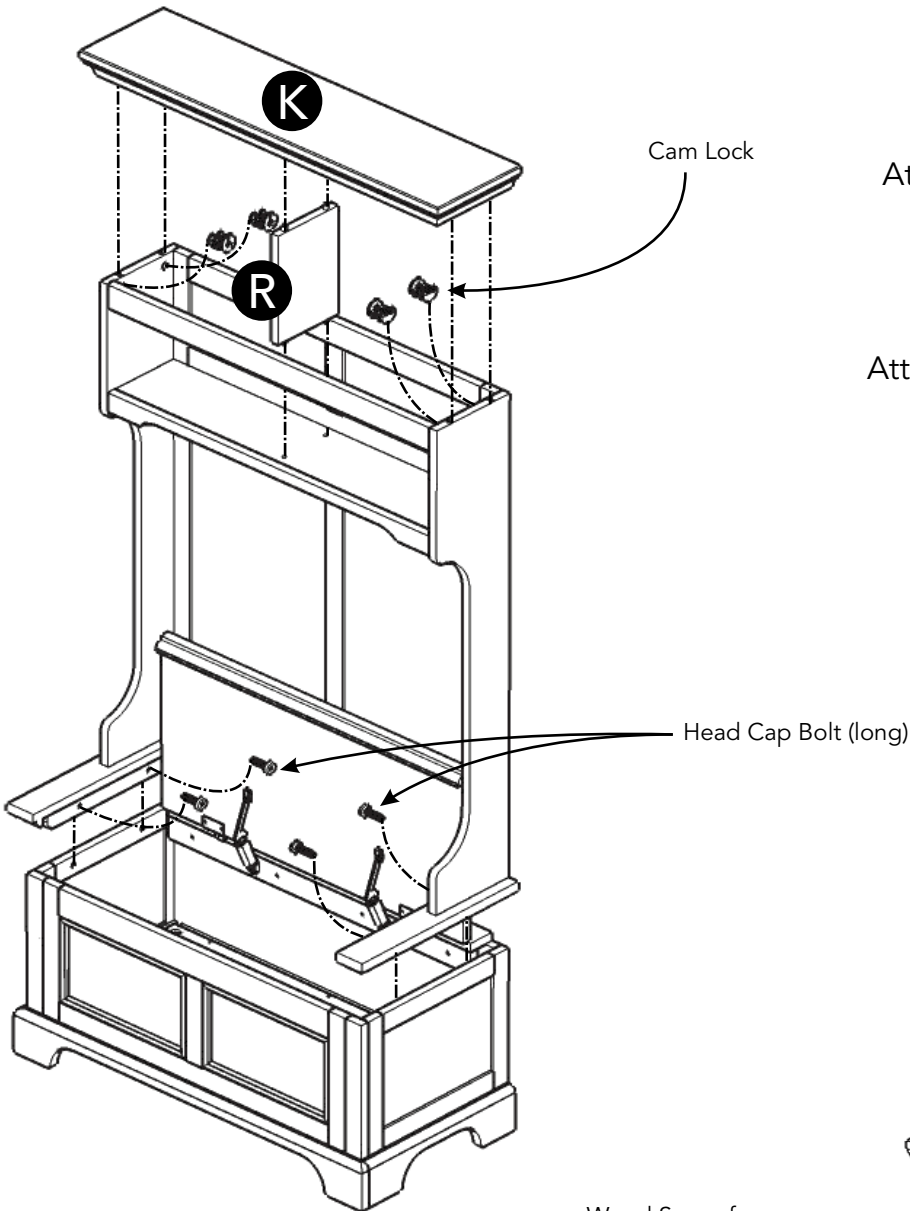

Attach unit from Step 13 to base unit with Head Cap Bolts (long).

Attach Divider (R) to unit.

Attach Top (K) to unit with Cam Locks.

## STEP 15

Level unit by adjusting the adjustable levelers on bottom of unit. (See Figure 7)

Insert Wood Screws for Back Panel into pre-drilled holes of unit, then tighten.

Note: Unit must be level before tightening these screws.

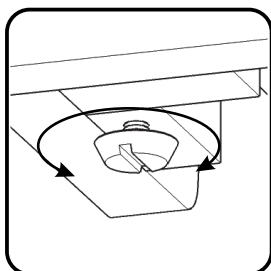
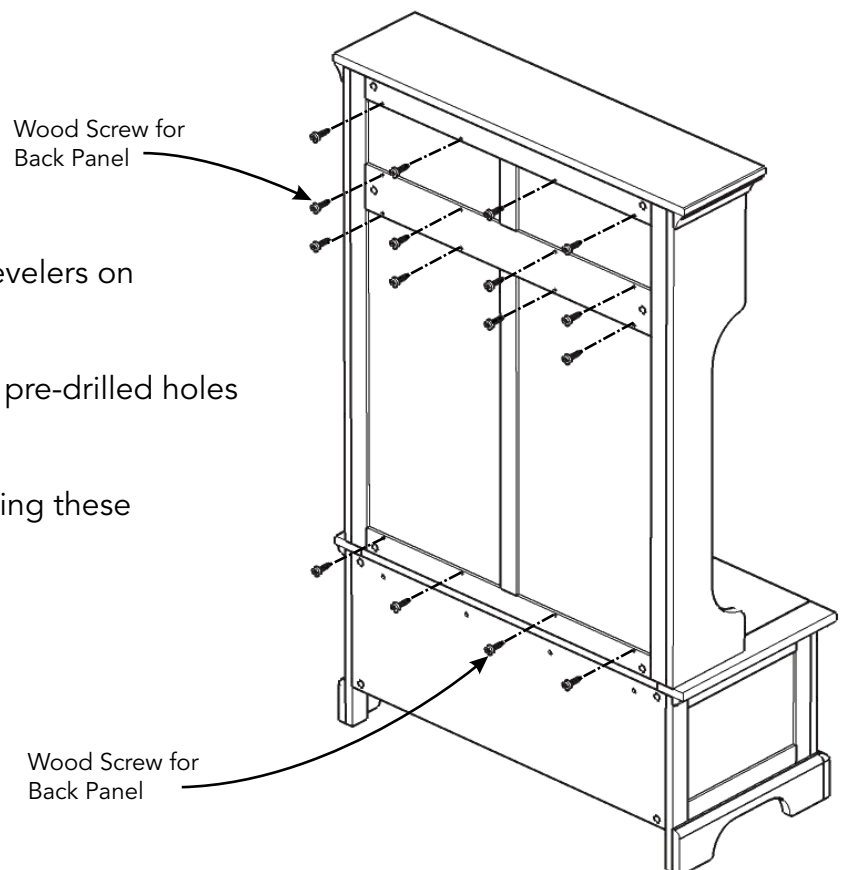

Figure 7



# Assembly Instructions 8/8

## IMPORTANT

• To help reduce the risk of the unit tipping over, the Tip-over Restraint must be installed following these instructions exactly.

## STEP 16

Place unit at desired location.

Drill a 3/8" hole in wall in-line with pre-drilled hole at top of unit.

Move unit.

Insert Anchor into the wall hole and attach Bracket with Wall Screw.

Attach Bracket at pre-drilled hole at top of unit with Wood Screw.

Move unit back into place.

Slide Tip-over Restraint through Bracket on wall and Bracket on unit. (See Figure 8)

Put tie end of Tip-over Restraint into lock end of Tip-over Restraint and pull until tight.

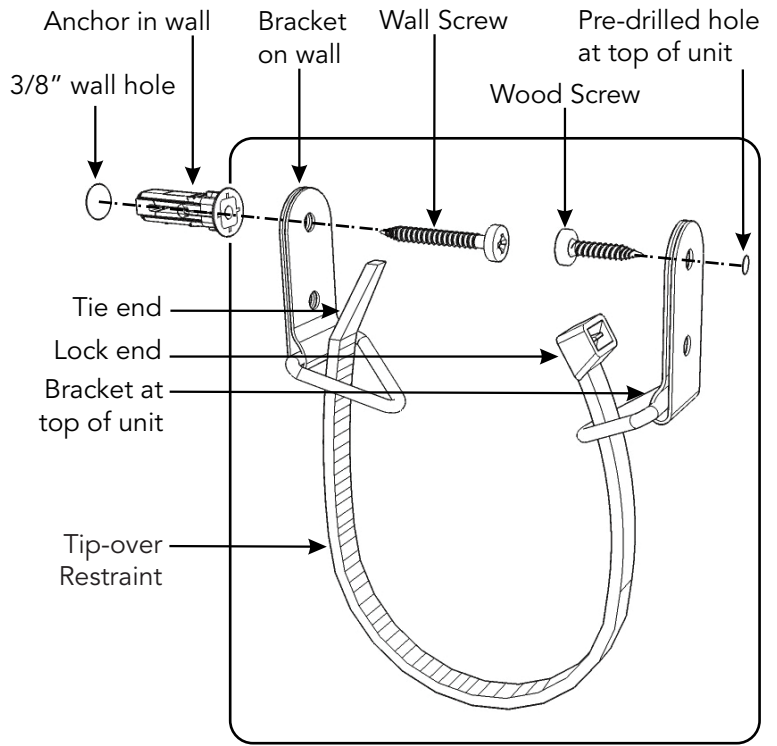
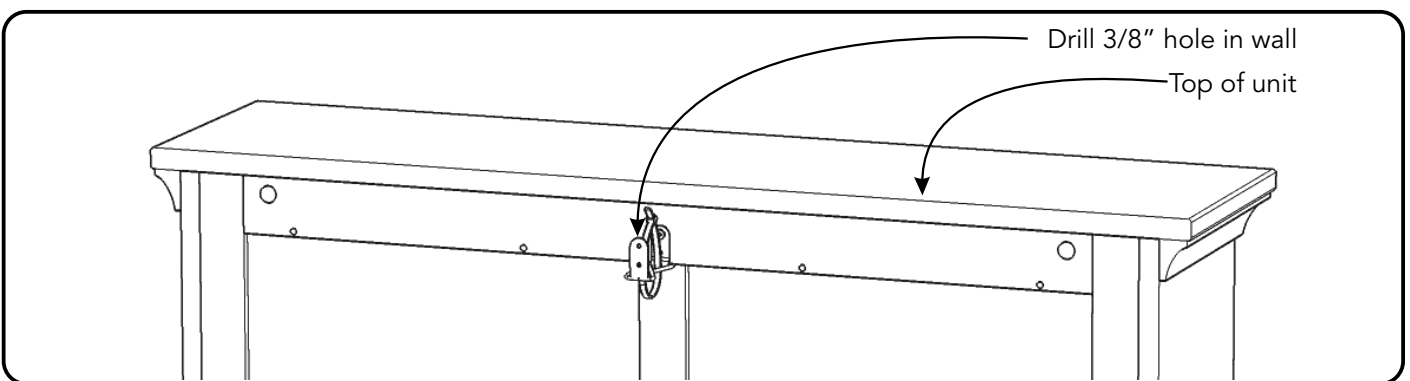
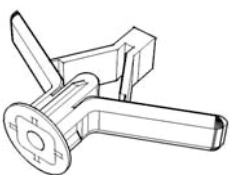

Figure 8



## Hardware List



Anchor  
1 pc. (+1 extra)



Bracket  
2 pcs. (+1 extra)

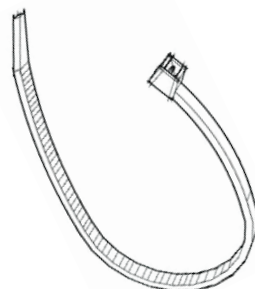

Tip-over Restraint  
1 pc. (+1 extra)

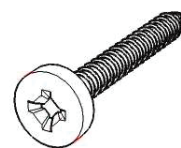

M3.5x40  
Wall Screw  
1 pc. (+1 extra)

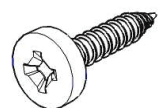

M3.5x13  
Wood Screw  
1 pc. (+1 extra)



# CARE INSTRUCTIONS

## NEVER

allow liquids to remain on furniture.  
Absorption causes parts to warp  
and split and finishes to delaminate.

## NEVER

use glass cleaners on  
finished furniture. Ammonia  
chemically attacks the finish.



Do not use power tools  
above 8 volts to assemble.

**PREVENT  
CRACKING**



Do not place  
in direct sunlight.

**PREVENT  
FADING**



Do not write  
directly on surface.

**PREVENT  
MARKING**



Do not place hot  
objects on surface.

**PREVENT  
FINISH DAMAGE**

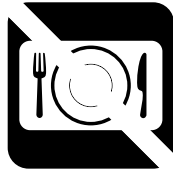

Do not use rubber  
based placemats.

**PREVENT  
DISCOLORING**



Do not use commercial  
waxes and polishes.

**PREVENT  
YELLOWING**

## CLEAN

with a soft cloth moistened  
in lukewarm soap and water.  
Buff with a dry clean cloth.



Home Styles will provide replacements free of charge for missing or damaged hardware or parts within 30 days of purchase. Digital images of the defective parts may be required. If the product was not purchased from an authorized retail affiliate, Home Styles is under no obligation to provide replacement parts. Parts are not available for fully assembled items nor are parts available for sale. Replacements for missing or damaged hardware or parts may be requested at:

[www.homestyles-furniture.com/customer-service/replacement-parts](http://www.homestyles-furniture.com/customer-service/replacement-parts)

Home Styles Customer Service: [www.homestyles-furniture.com](http://www.homestyles-furniture.com),  
[servicedesk@homestyles-furniture.com](mailto:servicedesk@homestyles-furniture.com), 888-680-7460, 877-831-0319