



Liberty Furniture
INDUSTRIES, INC

LIBERTY FURNITURE

ASSEMBLY INSTRUCTION

ITEM # 62-IT5446 / 62-IT5446B

DESCRIPTION KITCHEN ISLAND

Thank you for purchasing this quality product. Be sure to check all packing material carefully for small parts which may have come loose inside the carton during shipment. Identify and count all parts and compare with the parts list below :

STEP 7



STEP 8

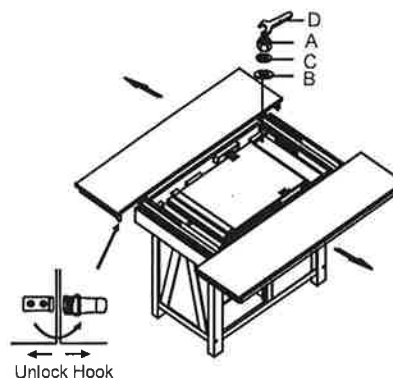

STEP 9



STEP 10

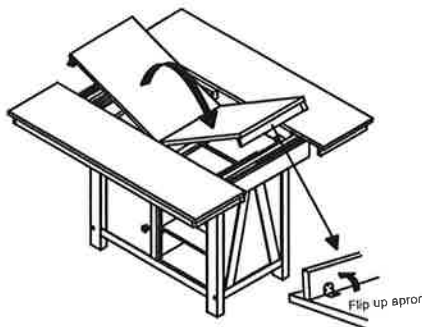

STEP 11

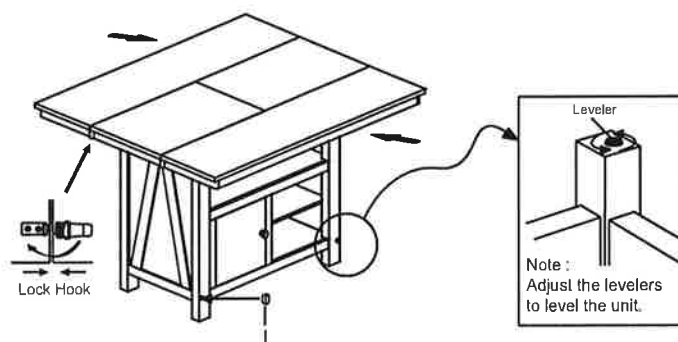

ASSEMBLY TIPS:

1. Remove hardware from box and sort by size.
2. Please check to see that all hardware and parts are present prior start of assembly.
3. Please follow attached instructions in the same sequence as numbered to assure fast and easy assembly.

⚠ WARNING!

1. Don't attempt to repair or modify parts that are broken or defective. Please contact the store immediately.
2. This product is for home use only and not intended for commercial establishments.



Liberty Furniture
INDUSTRIES, INC

LIBERTY FURNITURE

ASSEMBLY INSTRUCTION

ITEM # 62-IT5446 / 62-IT5446B

DESCRIPTION KITCHEN ISLAND

Thank you for purchasing this quality product. Be sure to check all packing material carefully for small parts which may have come loose inside the carton during shipment. Identify and count all parts and compare with the parts List Below :

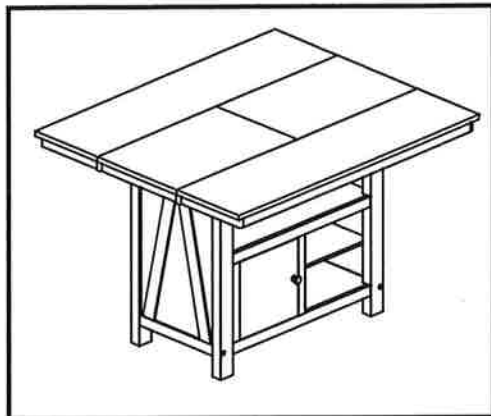

PARTS LIST

No	DESCRIPTION	SKETCH	QTY
1	Table Top Panel With Frame		1 Pce
2	Front frame		2 Pcs
3	Side frame		2 Pcs
4	Bottom Panel		1 Pce
5	Inner Panel		1 Pce
6	Shelf Panel		2 Pcs
7	Top Panel		1 Pce

ASSEMBLY HARDWARE PACK #1 8

NO.	SKETCH	HARDWARE	Q'TY
A		Hex Nut	4 pcs
B		Flat Washer(Large)	4 pcs
C		Lock Washer(Large)	4 pcs
D		Wrench	1 pce
E		JCBC Bolt	8 pcs
F		Flat Washer(Small)	8 pcs
G		Lock Washer(Small)	8 pcs
H		Allen Key	1 pce
I		Wood Plug	8 pcs

ASSEMBLY HARDWARE PACK #2 9

NO.	SKETCH	HARDWARE	Q'TY
J		Wood Knob	2 pcs
K		Truss Head Screw	2 pcs

ASSEMBLY STEP

STEP 1

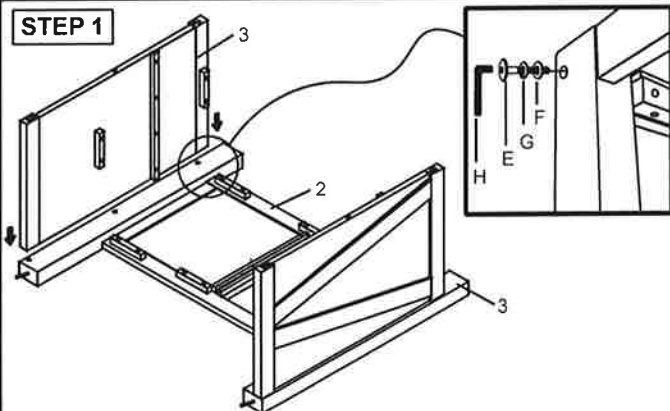

STEP 2

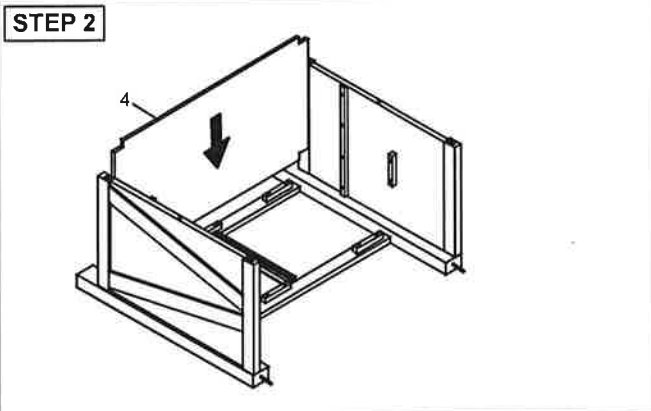

STEP 3

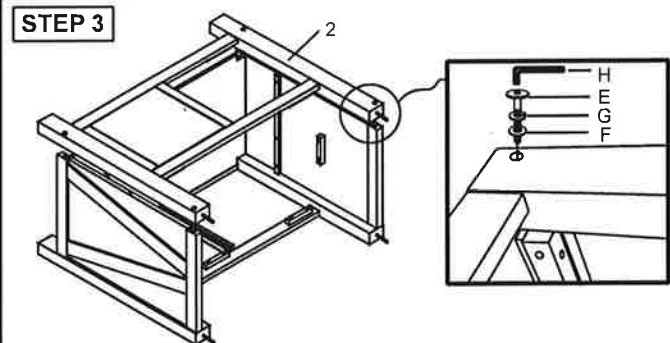

STEP 4

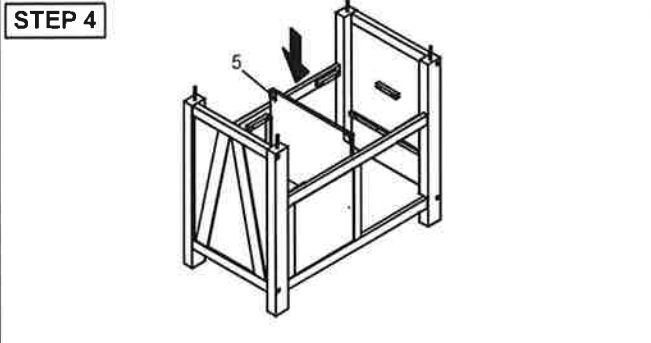

STEP 5

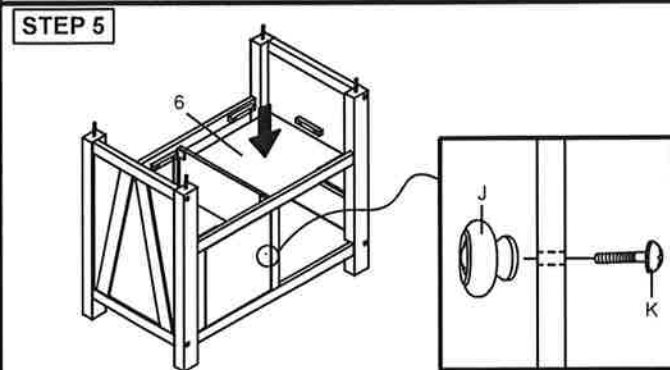

STEP 6

