



# Liberty Furniture

INDUSTRIES, INC

## LIBERTY FURNITURE

### ASSEMBLY INSTRUCTION

**DESCRIPTION: KING SLEIGH HEADBOARD**  
**KING SLEIGH FOOTBOARD**  
**SLEIGH BED RAILS**

**Item#: 455W-BR22H-BR22F-BR91**

Thank you for purchasing this quality product. Be sure to check all packing material carefully for small parts which may have come loose inside the carton during shipment. Identify and count all parts and compare with the parts List Below:

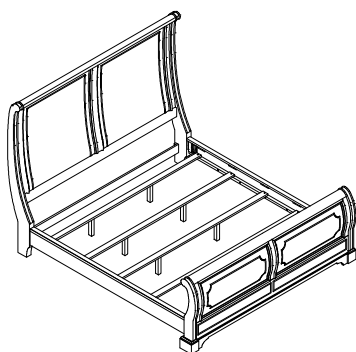

#### PART LIST:

① HARDWARE LIST				
NO.	Drawing	Description	Q'ty	
A		Threaded Bolt Ø5/16"x 3-1/2"	8pcs	
B		Flat washer (Ø5/16"x19mm)	8pcs	
C		Spring washer (Ø5/16")	8pcs	
D		Hex Nut (Ø5/16")	8pcs	
E		Ø5/16" Wrench(12mm)	1pc	
F		Wood screw Ø8 x 1"(KING BED)	10pcs	

		②	③	④
HEAD BOARD: 1PC	FOOT BOARD: 1PC	SIDE RAIL : 2PCS	SLATS: 5PCS	SUPPORT LEGS: 10PCS

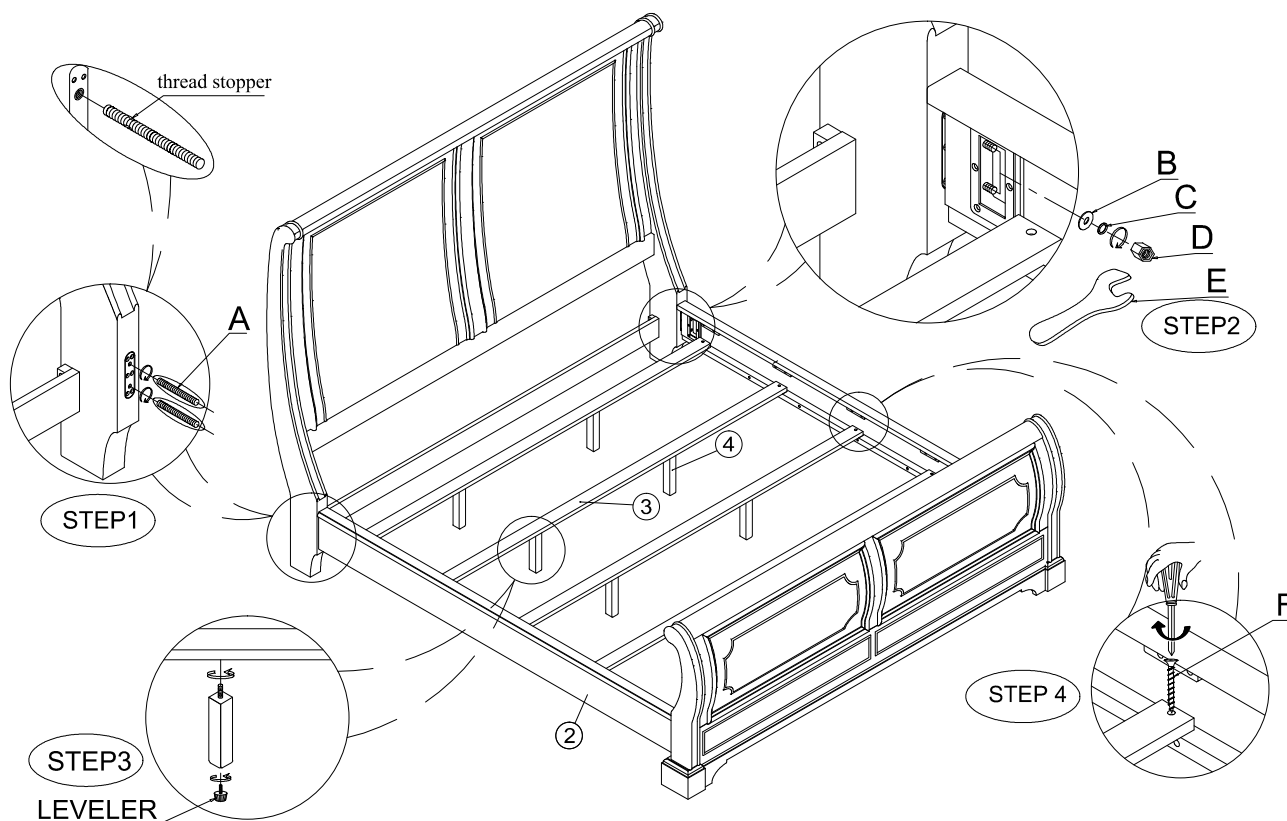

### CLEANING INSTRUCTION

Clean the Bed surface with a furniture polish and a soft cloth.

Made in VietNam