

## FEATURES

- Built-in or freestanding option for design versatility.
- Built-in trim kits available to match Wolf ovens.
- Large-capacity interior.
- Touch control panel with interactive visual display and 10 preset power levels.
- Sensor cooking to monitor and adjust settings.
- Popcorn, beverage, baked potato, frozen entree or vegetables, bacon reheat, keep warm, soften, Gourmet and defrost settings.
- Auto start and multiple sequence cooking features.
- Turntable is removable for easy cleaning.
- Menu label.
- Interior light and window in door.
- One-touch door open pad.
- Control panel lock.

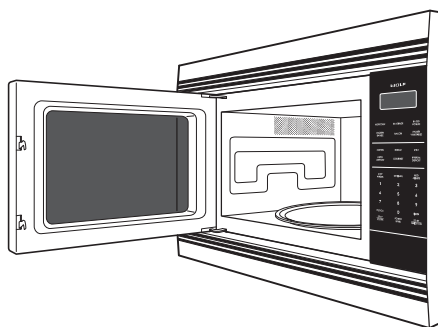

Model MS24 with L series stainless steel trim.

## MODEL

Standard

MS24

## ACCESSORIES

- Stainless steel and black glass trim kits to match Wolf ovens.

Accessories available through an authorized Wolf dealer. For local dealer information, visit the find a showroom section of our website, [wolfappliance.com](http://wolfappliance.com).

## SPECIFICATIONS

### PRODUCT

|                |  |
|----------------|--|
| Freestanding   | 24"W x 13 <sup>3</sup> / <sub>8</sub> "H x 19 <sup>1</sup> / <sub>8</sub> "D |
| Trim Height    | 18 <sup>1</sup> / <sub>4</sub> "   |
| 27" Trim Width | 26 <sup>7</sup> / <sub>8</sub> "   |
| 30" Trim Width | 29 <sup>7</sup> / <sub>8</sub> "   |
| Weight         | 50 lb  |

### OVEN INTERIOR

|            |   |
|------------|---|
| Capacity   | 2.0 cu ft   |
| Dimensions | 17 <sup>3</sup> / <sub>8</sub> "W x 10 <sup>1</sup> / <sub>2</sub> "H x 18 <sup>5</sup> / <sub>8</sub> "D |

### ELECTRICAL

|            |                |
|------------|----------------|
| Supply     | 120 VAC, 60 Hz |
| Service    | 15 amp circuit |
| Power Cord | 4'             |

### POWER RATING

|         |        |
|---------|--------|
| Maximum | 1200 W |
|---------|--------|

Specifications are subject to change without notice. Visit [wolfappliance.com/specs](http://wolfappliance.com/specs) for the most up-to-date information.

Dimensions may vary  $\pm 1/8"$  (3). Dimensions in parentheses are millimeters unless otherwise specified.

## DIMENSIONS

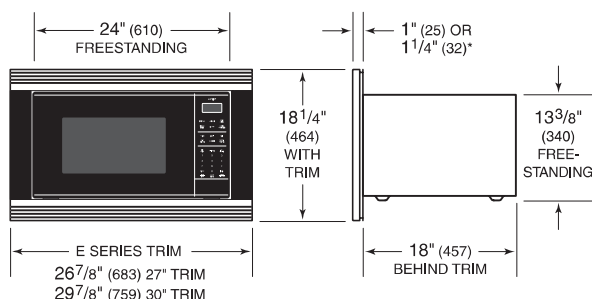
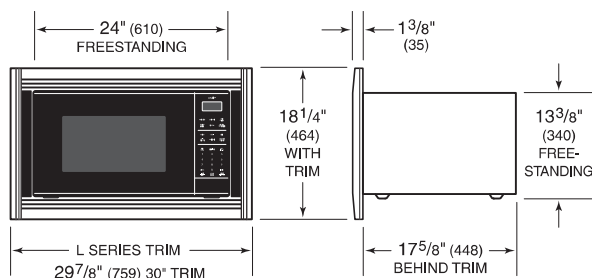

\*1<sup>1</sup>/<sub>4</sub>" (32) for contemporary E series trim only.

## STANDARD INSTALLATION

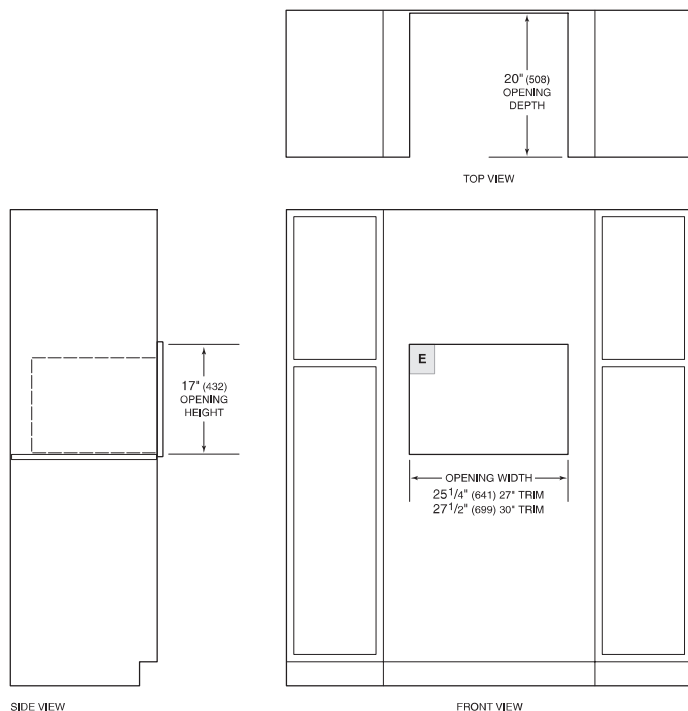

SIDE VIEW

FRONT VIEW

NOTE: Dashed line represents profile of unit.

## FLUSH INSET INSTALLATION

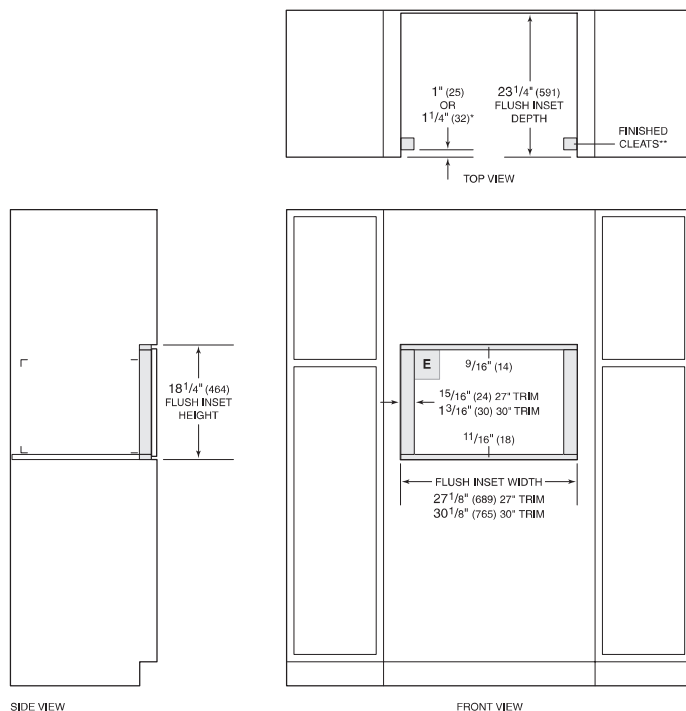

SIDE VIEW

FRONT VIEW

\*1<sup>1</sup>/<sub>4</sub>" (32) for contemporary E series trim only.

\*\*Will be visible and should be finished to match cabinetry.

NOTE: Dashed line represents profile of unit.