

ASSEMBLY INSTRUCTIONS  
B6960-Q-HBFB / B6960-KQ-RAIL  
BATESON QUEEN BED

CRWN

STEP 1

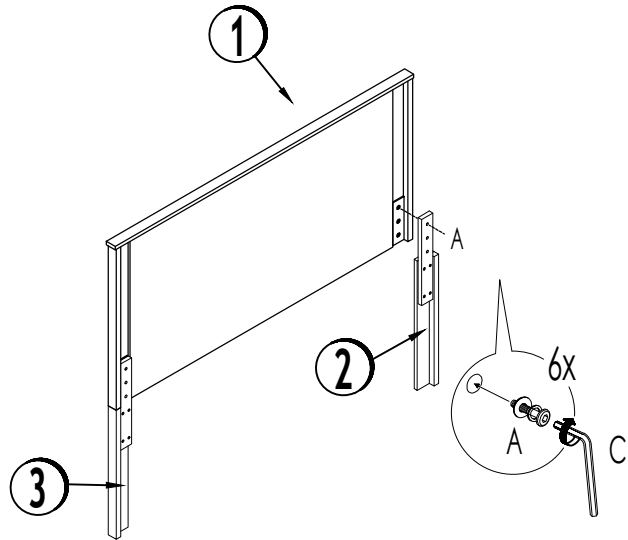

BACK VIEW

STEP 2

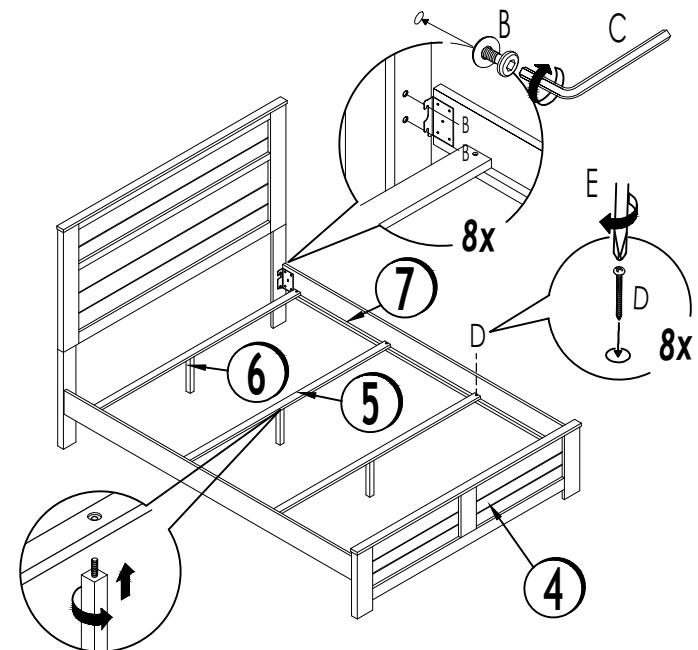

(BOX 1) - BOX OF HEADBOARD AND FOOTBOARD

PARTS LIST				HARDWARE LIST			
NO.	DESCRIPTION	SKETCH	QTY	NO.	DESCRIPTION	SKETCH	QTY
1	HEADBOARD PANEL		1	A	JCBB ( M8 x 35mm ) W/FLAT WASHER & SPRING WASHER		6
2	HEADBOARD LEG(R)		1	B	JCBB ( M8 x 20mm ) W/FLAT WASHER		8
3	HEADBOARD LEG(L)		1	C	ALLEN KEY ( M5 )		1
4	FOOTBOARD		1	D	PANHEAD ( M4 x 32mm )		8
5	WOODEN SLAT		4	E	SCREW DRIVER (*)		1
6	WOODEN SUPPORT		4	*The manufacturer does not provide item E.			

(BOX 2) - BOX OF SIDE RAIL

PARTS LIST			
NO.	DESCRIPTION	SKETCH	QTY
7	SIDE RAIL		2

**IMPORTANT NOTE :**

- \* Place all wooden parts on a clean and smooth surface such as a rug or carpet to avoid the parts from being scratched.
- \* Check to be sure that you have all parts and hardware.
- \* Remove all wrapping materials, including staples & packing straps before you start to assemble.
- \* Do not tighten all screws/bolts until all completely assembled.
- \* Keep all hardware parts out of reach of children.