

# Illustrated Parts for 9940

## WASTE KING

### Included Parts

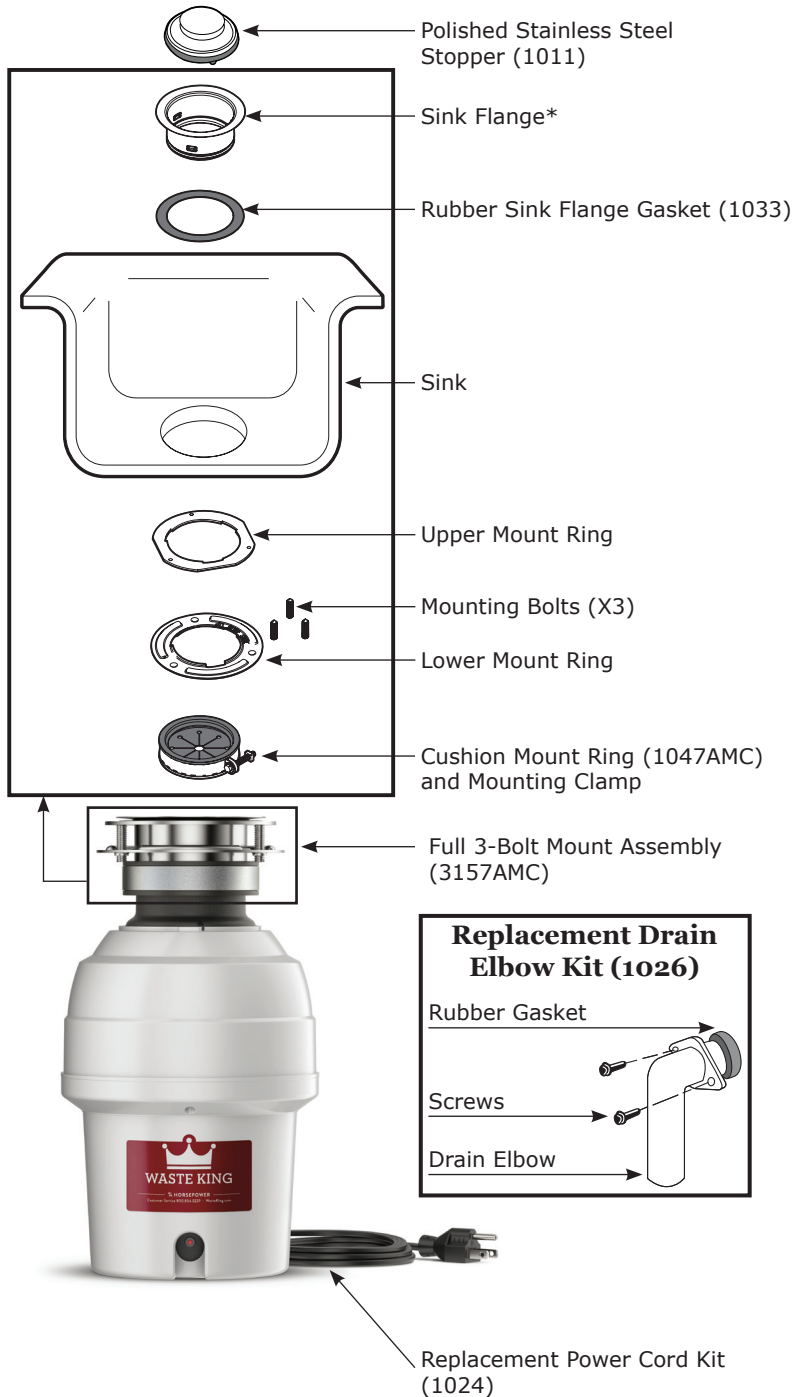

### Replacement Drain Elbow Kit (1026)

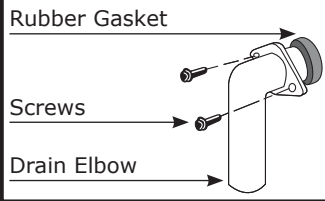

### Other Available Accessories



#### Air Switch Remote Controller

- Installs into existing sink hole (1-1/4") to operate disposer with plunger air switch.
- Perfect application for island counter tops or where electrical switch is unavailable.
- Plug-in: No wiring connections (continuously powered outlet required).

#### Air Switch Base Unit

|   |             |
|---|-------------|
| Air Switch Remote Controller                        | ARC-4200    |
| <b>Additional Air Switch Button Finish Options:</b> |             |
| Chrome  | AS-4201-CH  |
| Satin Nickel  | AS-4201-SN  |
| Polished Brass                                      | AS-4201-BR  |
| White   | AS-4201-WH  |
| Almond  | AS-4201-AL  |
| Biscuit   | AS-4201-BIS |



#### Extended 3-Bolt Sink Flange\* (accommodates sinks between 1/2" and 1-3/8")

|                          |         |
|--------------------------|---------|
| Polished Stainless Steel | 3140AMC |
| Satin Nickel             | 3141AMC |
| Brass                    | 3142AMC |



#### Decorative 3-Bolt Flange and Stopper\*

|                          |         |
|--------------------------|---------|
| Polished Stainless Steel | 3150AMC |
| Brass                    | 3151AMC |
| White                    | 3152AMC |
| Almond                   | 3153AMC |
| Satin Nickel             | 3154AMC |
| Oil Rubbed Bronze        | 3156AMC |

Dishwasher Connector Kit -  
(connects 1-1/4", 1" and 3/4" outside diameter  
dishwasher drain hoses to the dishwasher inlet)



**1023**

Unjamming Wrench



**1037**

Disposal purchase comes with all Included Parts,  
Other Available Accessories can be purchased separately

FOR MORE INFORMATION CALL: 1-800-854-3229  
WasteKing.com