

UWD1CW

LG SIGNATURE SideKick™ Pedestal Washer

LG SIGNATURE

KEY FEATURES

- 0.7 cu. ft. Capacity
- Compatible with Washer/Dryer Combo (LUWM101HWA)
- Detergent/Softener Dispenser
- Specialty Cycles - Perfect for Intimates, Hand Wash or Active Wear
- SmartDiagnosis™
- Electronic Control Panel with Dual LED Display
- NeveRust™ Stainless Steel Drum
- Direct Drive Motor with 10-Year Limited Warranty

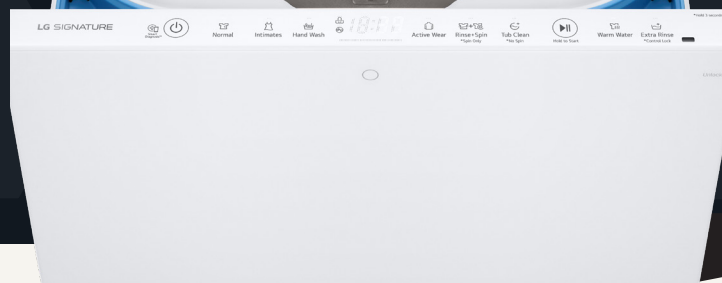

PRODUCT FEATURES

CAPACITY	
Capacity	.07 cu. ft.
APPEARANCE	
Electronic Control Panel with LED Display	Yes
Touch Buttons	Yes
WASH PROGRAMS	
3 Motion Technology	Yes
No. of Programs	5
Wash Programs	Normal, Intimates, Hand Wash, Active Wear, Rinse+Spin
No. of Options	6
Options	Spin Only, Tub Clean, Warm Water, Extra, Rinse, Control Lock
No. of Wash/Rinse Temps	2 (Warm, Cold)
CONVENIENCE FEATURES	
End of Cycle Signal	Yes
Child Lock	Yes
Auto Suds Removal	Yes
Forced Drain System	Yes
Leveling Legs	4 Adjustable Legs
SmartDiagnosis™	Yes
MOTOR AND AGITATOR	
Motor Type	Direct Drive Motor
Motor Speed	Variable
Max RPM	700
MATERIALS AND FINISHES	
NeveRust™ Stainless Steel Drum	Yes
Cabinet	Enamel
Control Panel	Plastic / Touch
Door Rim	Glass/ Chrome
Door Cover	Glass / Rectangle
All Available Colors	White (W)

POWER SOURCE	
Ratings	UL Listed
Electrical Requirements	120V, 5 Amps
Type	Electric
DIMENSIONS/CLEARANCES/WEIGHTS	
Product (W x H x D)	23 1/2" x 14 1/2" x 26" (42 1/8" with drawer open)
Carton (W x H x D)	27 1/2" x 17" x 27 1/2"
Product Weight (lbs)	95
Carton Weight (lbs)	105
LIMITED WARRANTY	
Parts and Labor	1 Year
Direct Drive Motor	10 Years
Drum	Limited Lifetime
UPC	
UWD1CW	195174006719

UWD1CW

LG SIGNATURE SideKick™ Pedestal Washer

QUICK INSTALL & CLEARANCES

For full installation directions/clearances please refer to the corresponding User Manual and Installation Guide.

DIMENSIONS	
Product (WxHxD)	23 1/2" x 14 1/2" x 26"
Depth with Drawer Open	42 1/8"
Carton Dimensions (in) (W x H x D)	27 1/2" x 17" x 27 1/2"
POWER RATINGS	
Ratings	UL Listed
Electrical Requirements	120V, 10 Amps



PRODUCT DIMENSIONS AND CLEARANCES

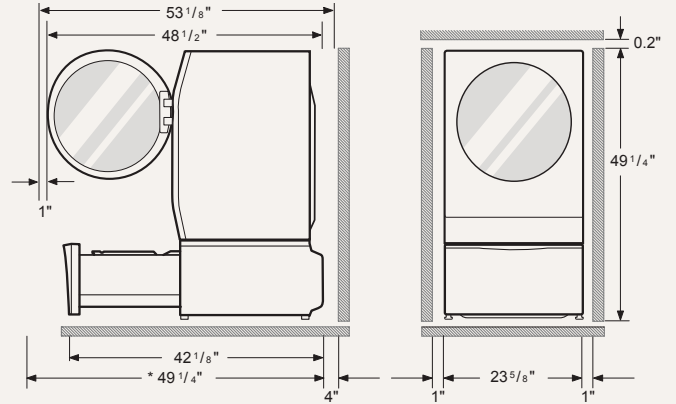

* 49 1/4" : Minimum space for installation

● To ensure sufficient clearance for water lines, the drain line and airflow, allow minimum clearances of at least 1 inch (2.5 cm) at the sides and 4 inches (10 cm) behind the unit. Be sure to allow for wall, door, or floor moldings that may increase the required clearances.

NOTE

● Do not use a drip pan as it can block the drawer. Using a drip pan may result in increased vibration and noise during operation.

INSTALLATION OVERVIEW

Please read the Owner's Manual installation instructions first after purchasing this product or transporting it to another location.

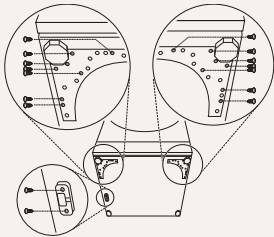

Assembling front brackets

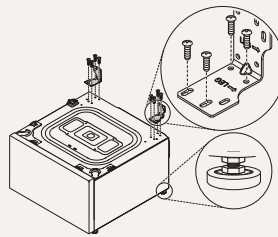

Assembling back brackets and if installing on wood flooring, anti-vibration foot pads

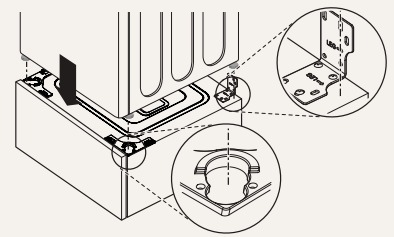

Placing Main Washer on top of the Mini Washer

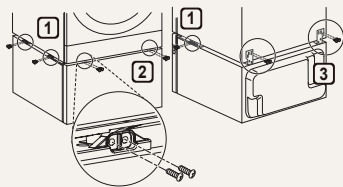

Attaching appliances to each other and snugging up the Main Washer

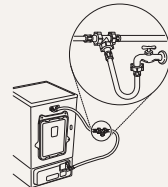

Connecting the water line

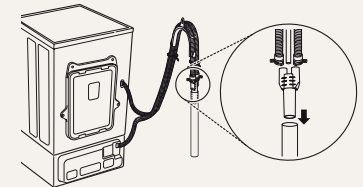

Connecting the drain line

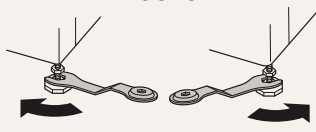

leveling

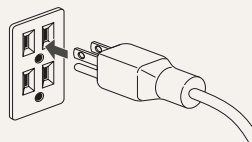

Connecting to the power supply

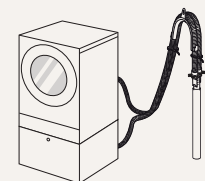

Testing the washer