

Warning :

- Be sure to check all packing material carefully for small parts, which may have come loose inside the carton during shipment.
- To prevent possible scratches and damage, this furniture **MUST BE ASSEMBLED BY TWO PEOPLE** on a soft surface such as a blanket or carpet.

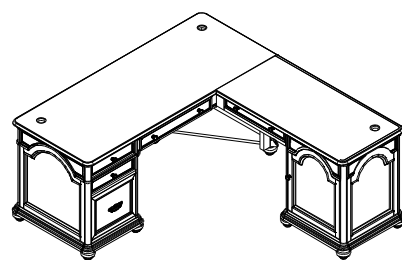

Components and Hardware List

Return Desk Back Panel (A) 1 pc.	Return Desk Top Panel (B) 1 pc.	Knee-Hole Section (C) 1 pc.	Pedestal (D) 1 pc.	L-Desk (E) 1 pc.		
Bun Feet (F) 11 pcs.	4mm Allen Key (G) 1 pc.	5mm Allen Key (H) 1 pc.	Allen Head Bolt 5/16"x 1-1/4" (inch) (I) 4 pcs.	Allen Head Bolt 5/16"x 1-3/4" (inch) (J) 2 pcs.	Allen Head Bolt 5/16"x 2-3/4" (inch) (K) 4 pcs.	Allen Head Bolt 1/4"x 1-3/8" (inch) (L) 8 pcs.
Flat Washer 5/16"x19x2 (Ø Biggest) (M) 10 pcs.	Spring Washer 5/16"x 12 x 3 (N) 10 pcs.	Flat Washer 1/4"x19x2 (Ø Biggest) (P) 8 pcs.	Spring Washer 1/4"x 12 x 3 (Q) 8 pcs.	Pencil Tray (R) 2 pcs.		

47232 L-Desk And Return

Step 1: REMOVE DRAWER

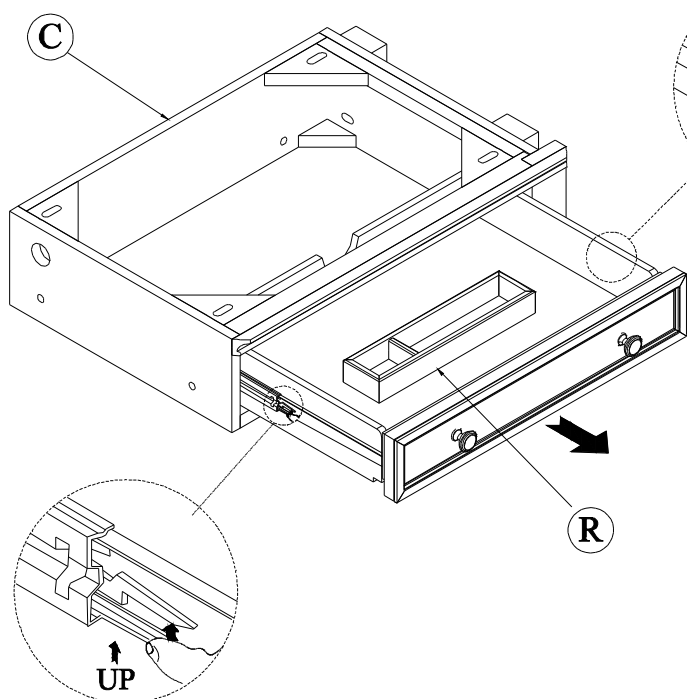

Step 2

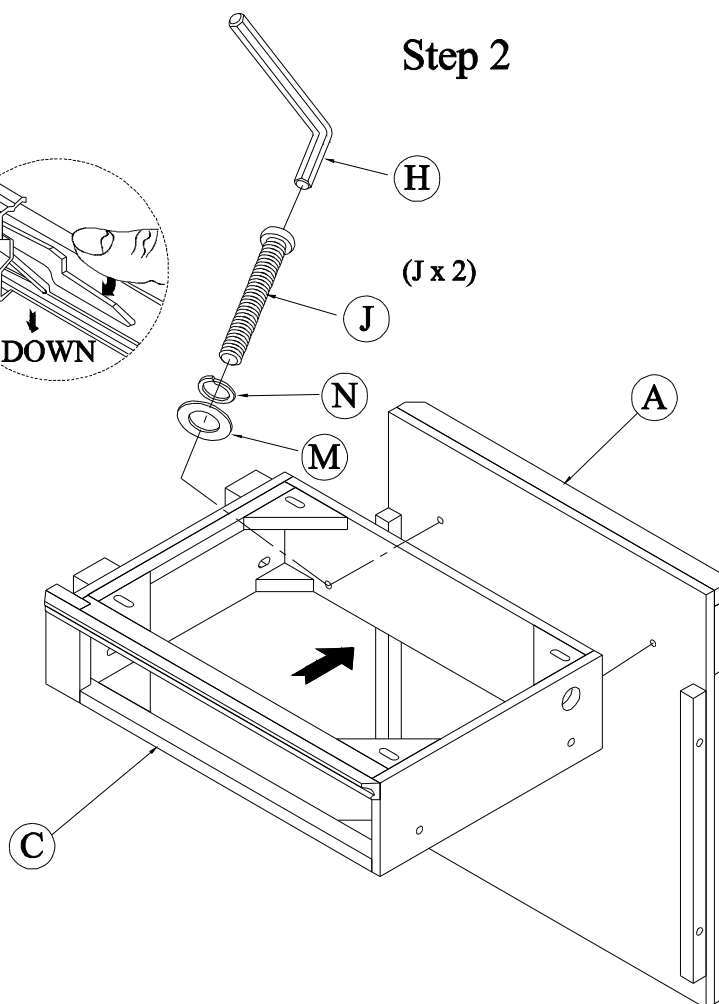

Step 3

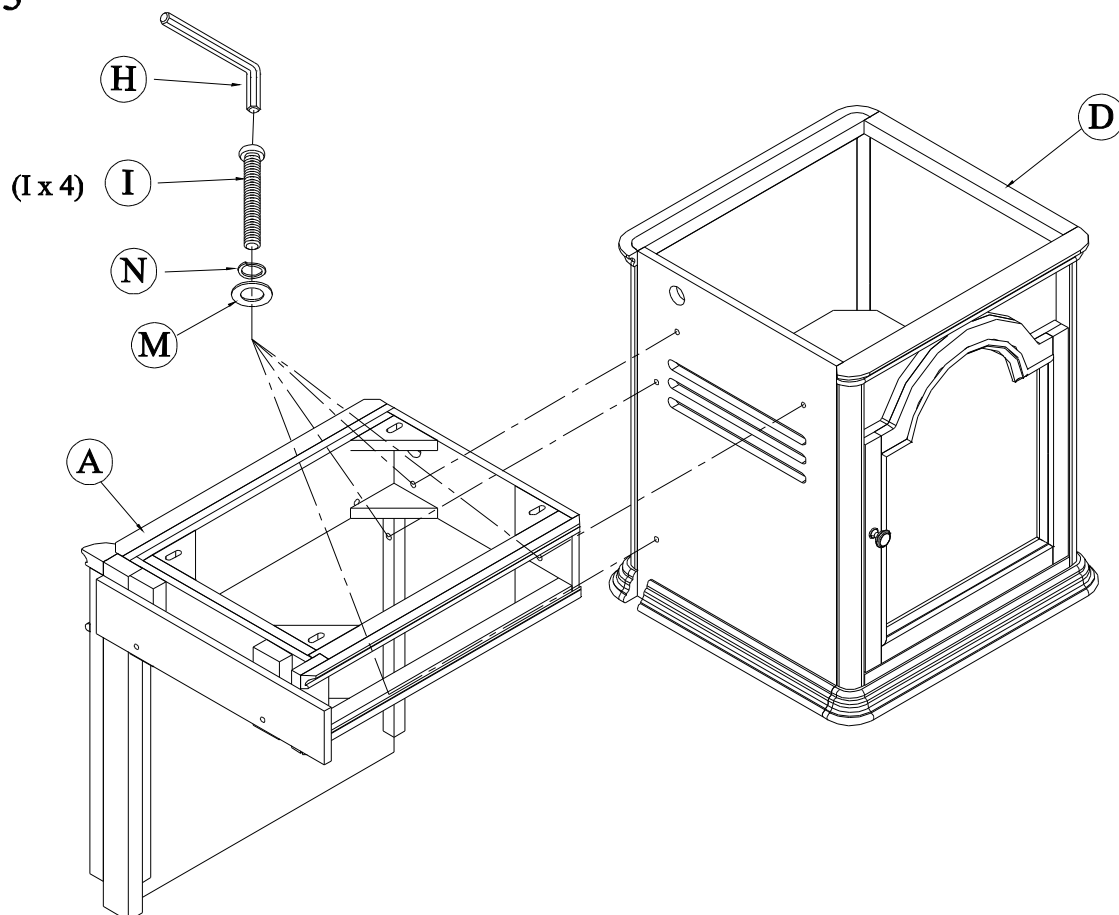

Step 4

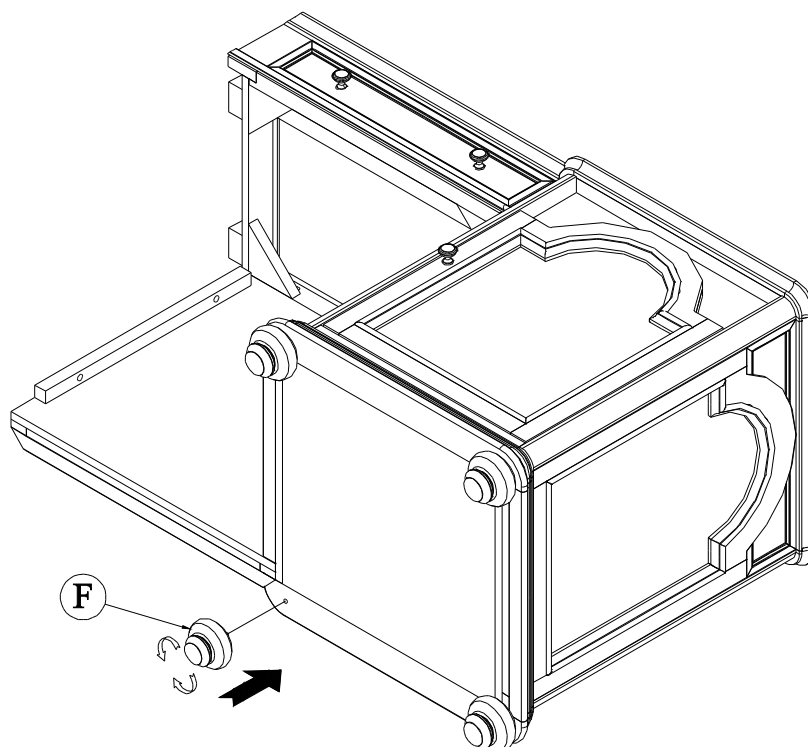

Step 5

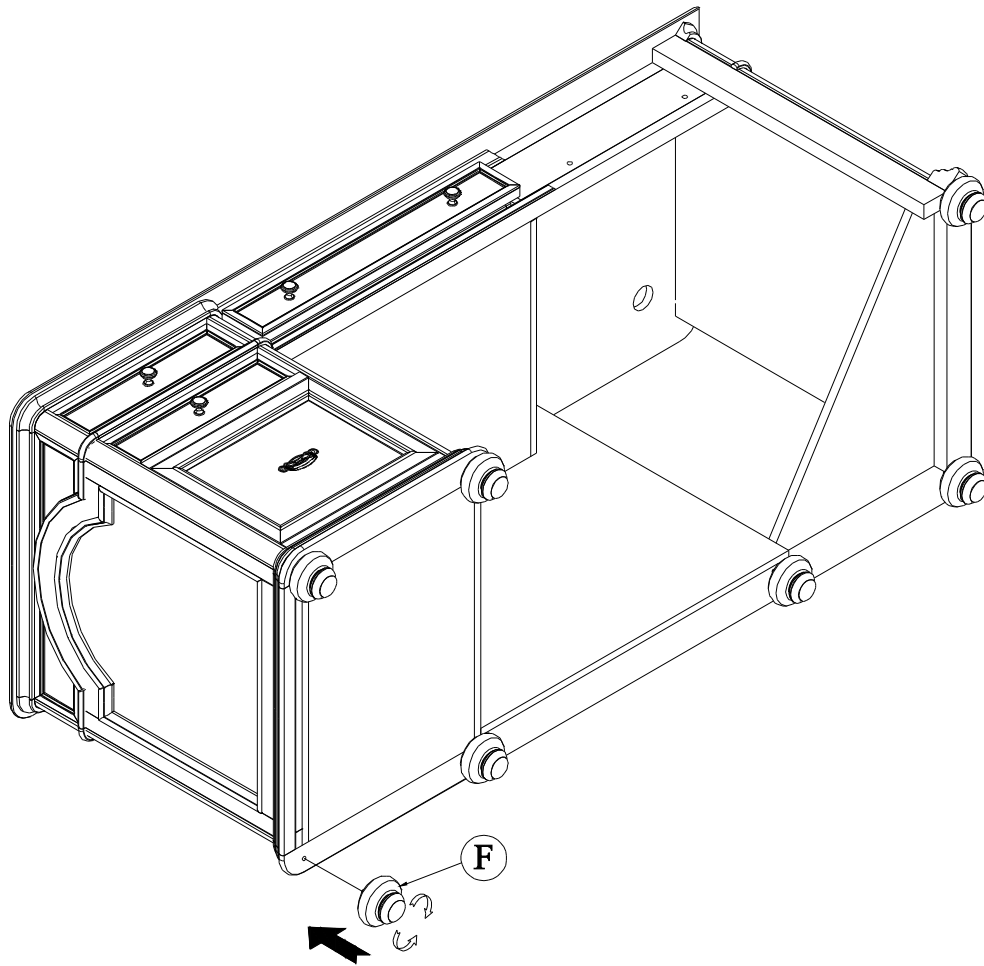

Step 6

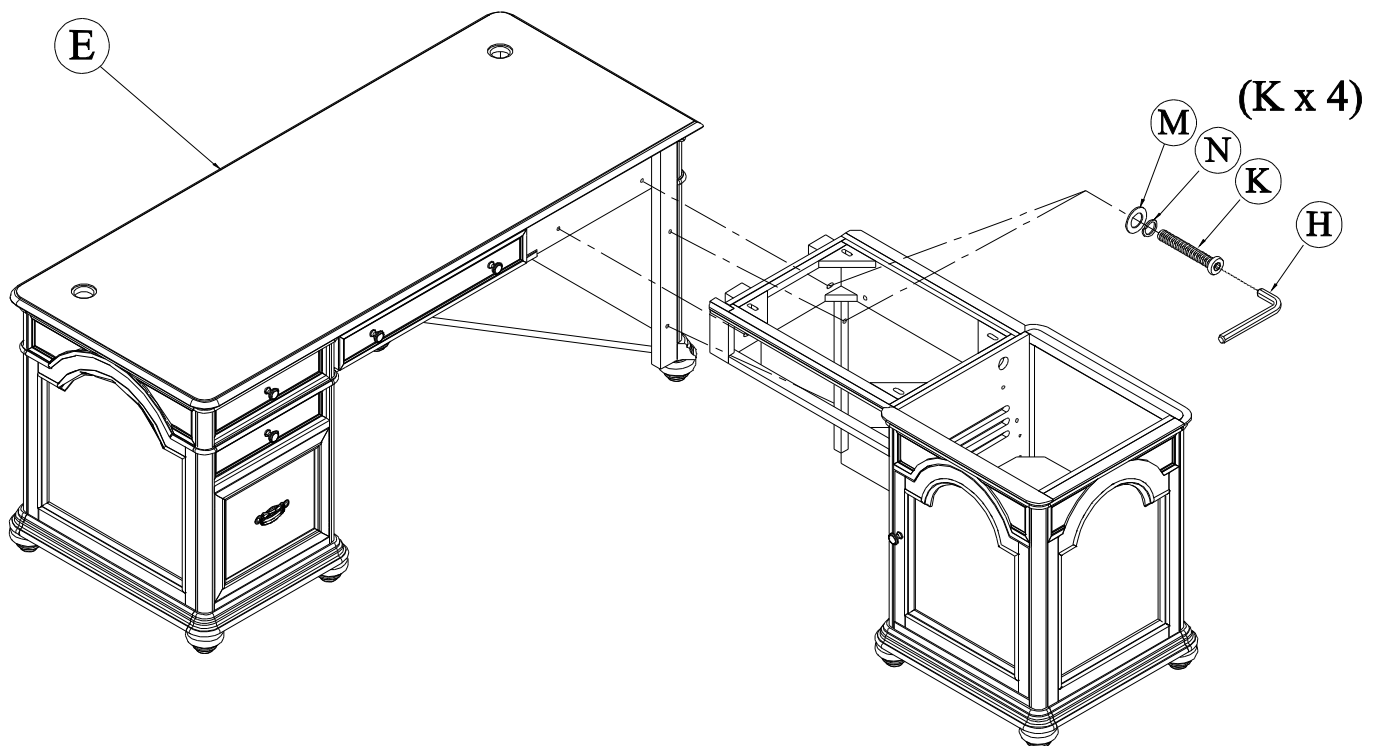

Step 7

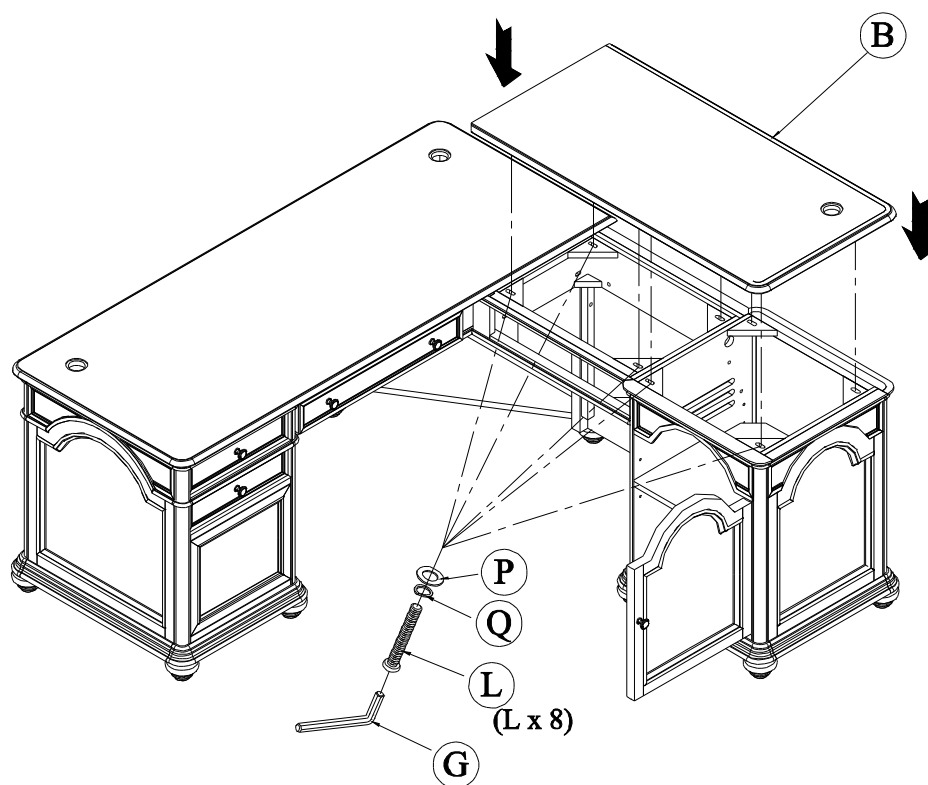

Step 8

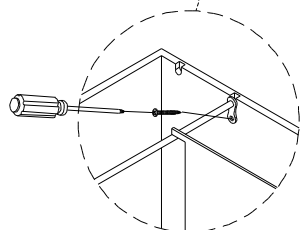
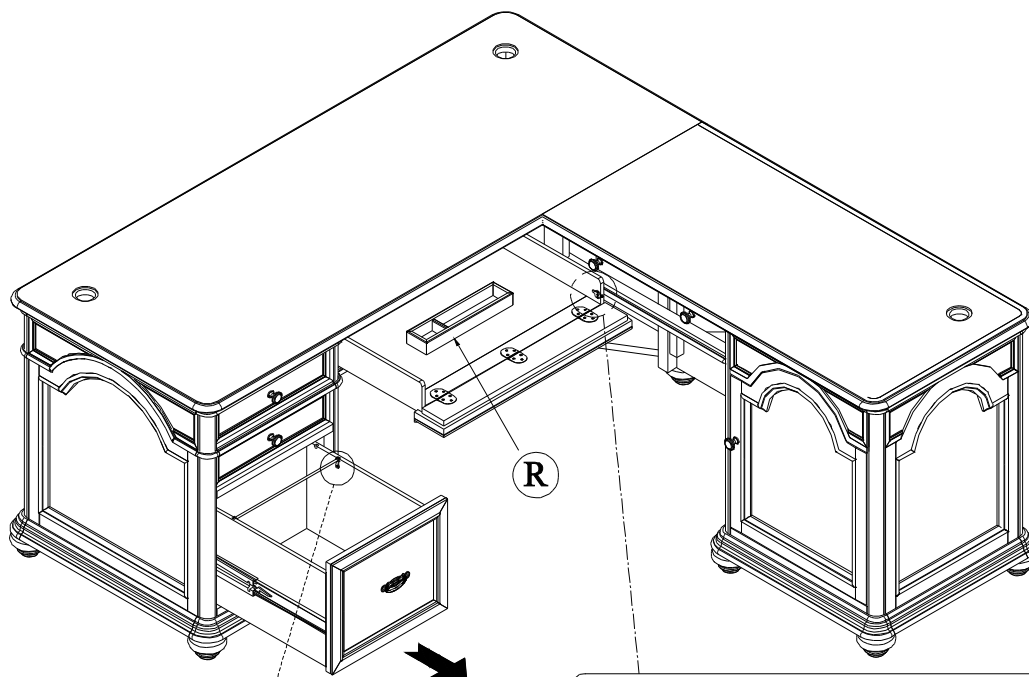

Unscrew to adjust the file rod

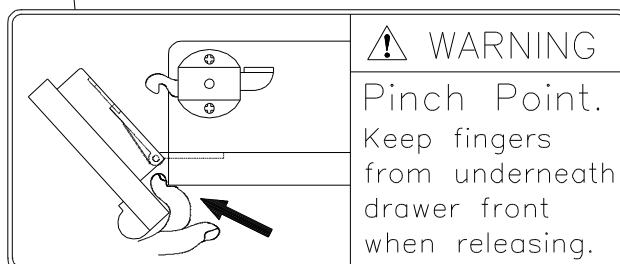

Step 9

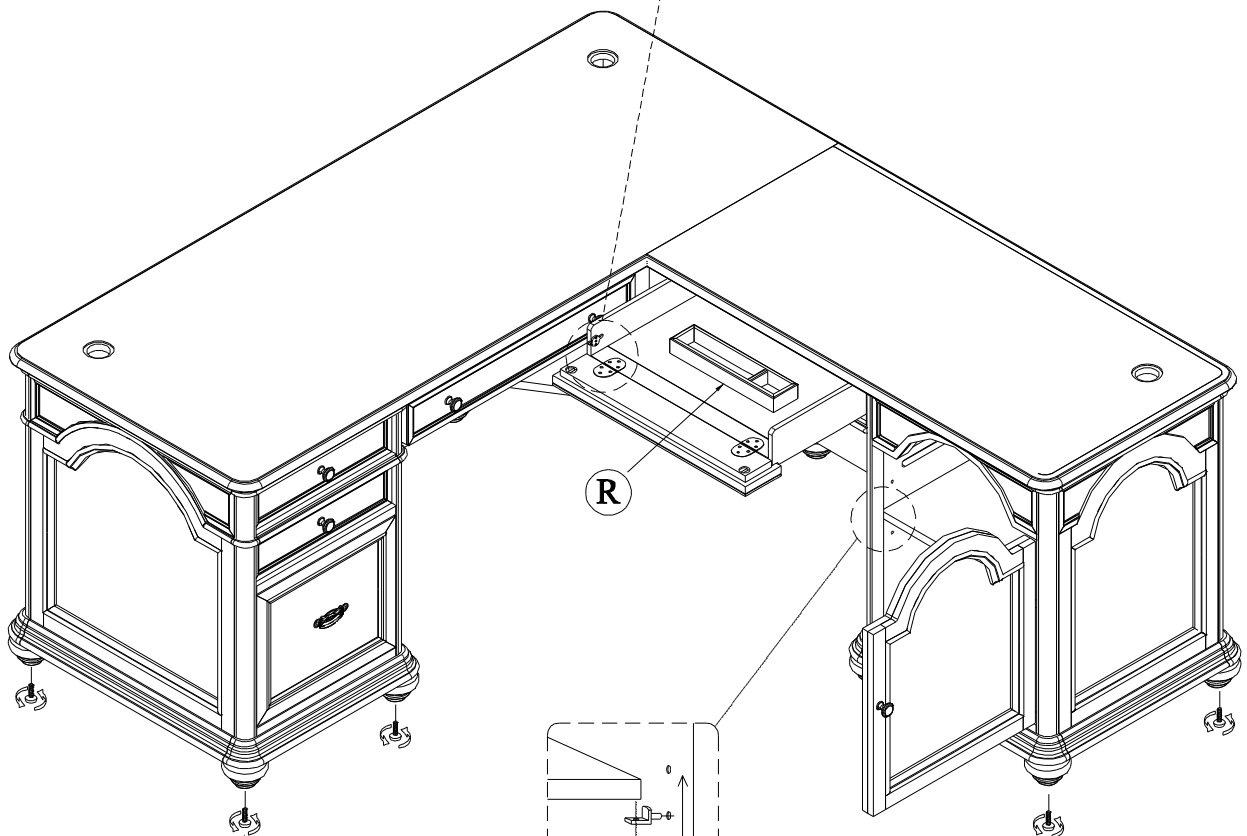
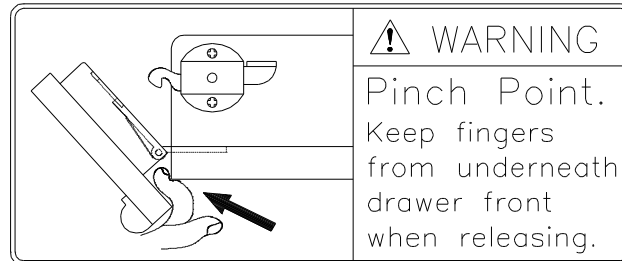

Adjustable leveler 11pcs

Unscrew to adjust
the shelf height